



# PROTECTRON ELECTROMECH (P) LTD

DESCRIPTION : 5 x 20, CERAMIC CARTRIDGE TIME DELAY FUSE  
RoHS

PART NO: PSTC In-R



<b>SPECIFICATIONS</b>	:	IEC 60127-2, SHEET-V(1A-6.3A)
<b>RATED VOLTAGE</b>	:	250 V
<b>BREAKING CAPACITY</b>	:	1500AMPS, WHEN TESTED WITH AC CURRENT
<b>CAP</b>	:	BRASS, NICKEL PLATED
<b>BODY</b>	:	CERAMIC BODY

## MARKINGS ON THE FUSE CAP SHOULD BE AS FOLLOWS:-

TYPE OF FUSE (F), FUSE RATING, RATED VOLTAGE (250V),  
BREAKING CAPACITY (L), RoHS(R) & COMPANY'S IDENTIFICATION

NOMINAL CURRENT (In)	2.1 In MAX.	2.75 In		4 In		10 In	
		MIN.	MAX.	MIN.	MAX.	MIN.	MAX.
0.1A TO 0.8A	30 MINUTES	250 mSec	80 Sec	50 mSec	5 Sec	5 mSec	150 mSec
>0.8A TO 3.15A	30 MINUTES	750 mSec	80 Sec	95 mSec	5 Sec	10 mSec	150 mSec
>3.15A	30 MINUTES	750 mSec	80 Sec	150 mSec	5 Sec	10 mSec	150 mSec
8 & 10A	30 MINUTES	750 mSec	80 Sec	150 mSec	5 Sec	10 mSec	150 mSec
>10A	30 MINUTES	1 Sec	80 Sec	150 mSec	5 Sec	20 mSec	100 mSec



# PROTECTRON ELECTROMECH (P) LTD

DESCRIPTION : 5 x 20, CERAMIC CARTRIDGE TIME DELAY FUSE  
RoHS

PART NO: PSTC In-R

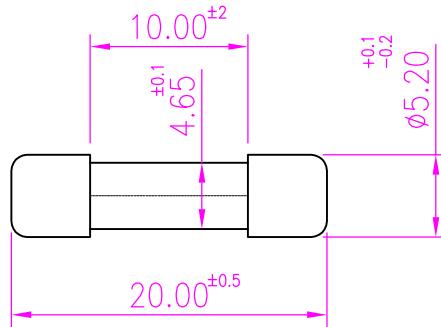

SL.NO	PEPL PART NUMBER	NOMINAL CURRENT RANGE (In)	VOLTAGE DROP DC (mV Max.)
1	PSTC 0.1A-R	100 mA	2500
2	PSTC 0.125A-R	125 mA	2000
3	PSTC 0.16A-R	160 mA	1900
4	PSTC 0.2A-R	200 mA	1500
5	PSTC 0.25A-R	250 mA	1300
6	PSTC 0.315A-R	315 mA	1100
7	PSTC 0.4A-R	400 mA	1000
8	PSTC 0.5A-R	500 mA	900
9	PSTC 0.63A-R	630 mA	300
10	PSTC 0.8A-R	800 mA	250
11	PSTC 1A-R	1 A	250
12	PSTC 1.25A-R	1.25 A	250
13	PST 1.4A-R	1.4 A	200
14	PST 1.5A-R	1.5 A	200
15	PST 1.6A-R	1.6 A	200

SL.NO	PEPL PART NUMBER	NOMINAL CURRENT RANGE (In)	VOLTAGE DROP DC (mV Max.)
16	PSTC 2A-R	2 A	190
17	PSTC 2.5A-R	2.5 A	180
18	PSTC 3A-R	3 A	140
19	PSTC 3.15A-R	3.15 A	140
20	PSTC 4A-R	4 A	100
21	PSTC 5A-R	5 A	100
22	PSTC 6.3A-R	6.3 A	100
23	PSTC 7A-R	7 A	100
24	PSTC 8A-R	8 A	100
25	PSTC 10A-R	10 A	100
26	PSTC 12A-R	12 A	100
27	PSTC 15A-R	15 A	100
28	PSTC 16A-R	16 A	100
29	PSTC 25A-R	25 A	100
30	PSTC 30A-R	30 A	100

A	ORIGINAL	RAMYA	13.08.2018	SACHIN		
REV.	DESCRIPTION		DRN. BY	DATE	CK'ED BY	APP'D BY
Projection: 		Scale: NTS	Sht. Size: A4	Gen. Tol.: ±0.1mm ±0.2°	ALL DIMENSIONS ARE IN MM. IF UNLESS OTHERWISE SPECIFIED.	