



PROTECTRON ELECTROMECH (P) LTD

DESCRIPTION : 5.2 x 20, GLASS CARTRIDGE TIME DELAY FUSE

PART NO: PST In

APPROVALS:

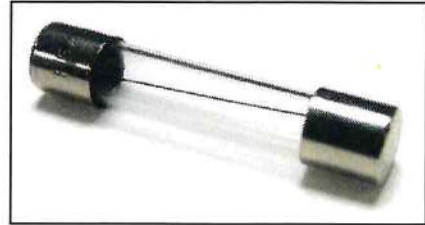

SPECIFICATIONS	:	IEC 60127-2, SHEET-III
RATED VOLTAGE	:	250 V
BREAKING CAPACITY	:	35 A, AC CURRENT
OPERATING TEMPERATURE	:	-55°C TO +125°C
CAP	:	BRASS, NICKEL PLATED
BODY	:	GLASS BODY

MARKINGS ON THE FUSE CAP SHOULD BE AS FOLLOWS:-

TYPE OF FUSE (T), FUSE RATING, RATED VOLTAGE (250V),
BREAKING CAPACITY (L) & COMPANY'S IDENTIFICATION

NOTE:

UL APPROVAL-1A TO 6.3A, 8A AND 10A

ADDITIONAL TEST(FOR<10A) AT 1.5In SHALL NOT FUSE WITHIN 1HOUR

NOMINAL CURRENT (In)	2.1 In MAX.	2.75 In		4 In		10 In	
		MIN.	MAX.	MIN.	MAX.	MIN.	MAX.
32mA TO 100 mA	2 MINUTES	200 mSec	10 Sec	40 mSec	3 Sec	10 mSec	300 mSec
>100mA TO 7.5A&9A	2 MINUTES	600 mSec	10 Sec	150 mSec	3 Sec	20 mSec	300 mSec
8 & 10A	2 MINUTES	500 mSec	10 Sec	150 mSec	3 Sec	20 mSec	300 mSec
>10A	2 MINUTES	600 mSec	10 Sec	150 mSec	3 Sec	20 mSec	300 mSec



PROTECTRON ELECTROMECH (P) LTD

DESCRIPTION : 5.2 x 20, GLASS CARTRIDGE TIME DELAY FUSE

PART NO: PST In

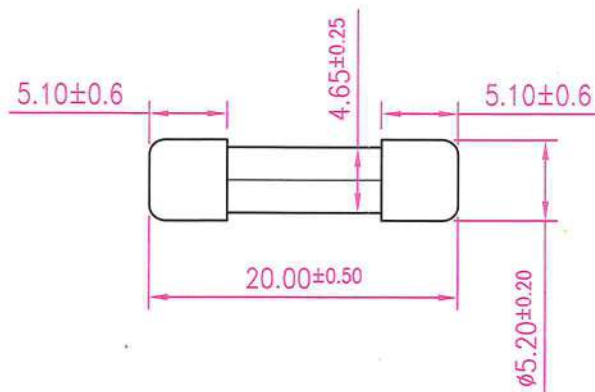

NOTE:FOR MANUAL ASSEMBLY AND OUT SIDE SOLDERING TOTAL LENGTH $20.0+1.0/-0.5$ mm

SL.NO	PEPL PART NUMBER	NOMINAL CURRENT RANGE (In)	VOLTAGE DROP DC (mV Max.)
1	PST 0.1A	100 mA	2500
2	PST 0.125A	125 mA	2000
3	PST 0.15A	150 mA	1900
4	PST 0.16A	160 mA	1900
5	PST 0.2A	200 mA	1500
6	PST 0.25A	250 mA	1300
7	PST 0.3A	300 mA	1100
8	PST 0.315A	315 mA	1100
9	PST 0.35A	350 mA	1100
10	PST 0.4A	400 mA	1000
11	PST 0.5A	500 mA	900
12	PST 0.6A	600 mA	300
13	PST 0.63A	630 mA	300
14	PST 0.7A	700 mA	250
15	PST 0.75A	750 mA	250
16	PST 0.8A	800 mA	250
17	PST 1A	1 A	150
18	PST 1.25A	1.25 A	150
19	PST 1.4A	1.4 A	150
20	PST 1.5A	1.5 A	150

SL.NO	PEPL PART NUMBER	NOMINAL CURRENT RANGE (In)	VOLTAGE DROP DC (mV Max.)
21	PST 1.6A	1.6 A	150
22	PST 2A	2 A	150
23	PST 2.5A	2.5 A	120
24	PST 3A	3 A	100
25	PST 3.15A	3.15 A	100
26	PST 3.5A	3.5 A	100
27	PST 4A	4 A	100
28	PST 5A	5 A	100
29	PST 6A	6 A	100
30	PST 6.3A	6.3 A	100
31	PST 7A	7 A	100
32	PST 8A	8 A	100
33	PST 9A	9 A	100
34	PST 10A	10 A	100
35	PST 12A	12 A	100
36	PST 15A	15 A	100
37	PST 16A	16 A	100
38	PST 20A	20 A	100
39	PST 30A	30 A	100



PROTECTRON ELECTROMECH (P) LTD

DESCRIPTION : 5.2 x 20, GLASS CARTRIDGE TIME DELAY FUSE

PART NO: PST In

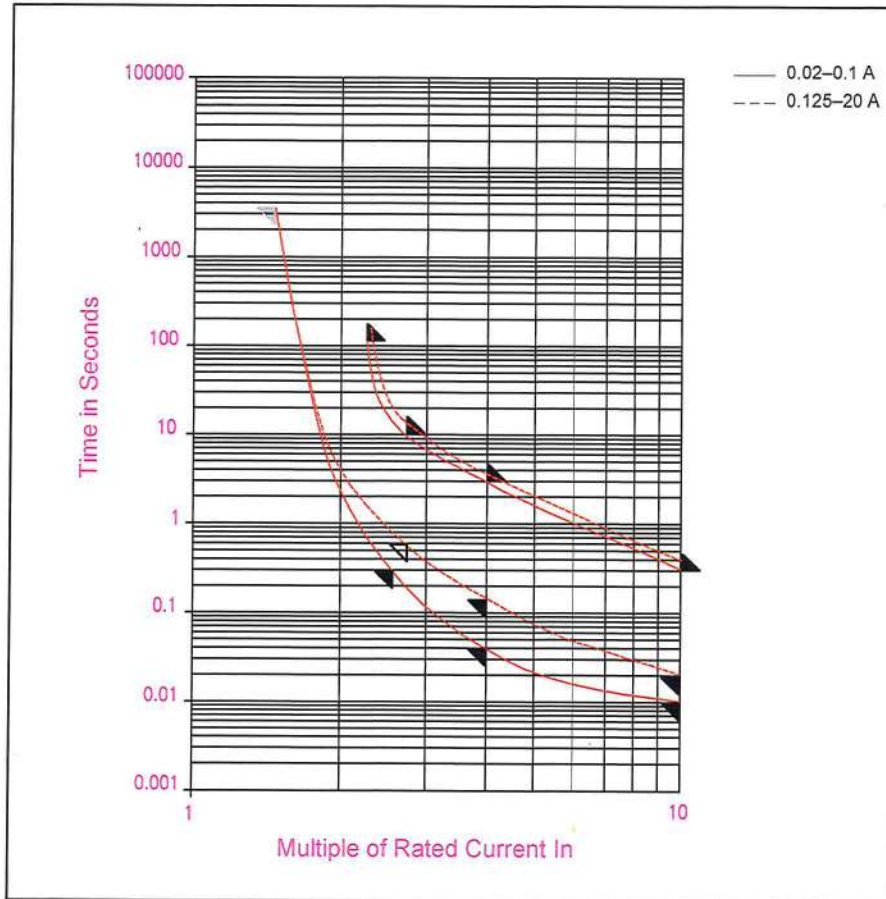

ORDERING INFORMATION

PST... mA($I_n \leq 800\text{mA}$) OR
PST... A($I_n \geq 1\text{A}$)

A7	OPERATING TEMPERATURE ADDED	PRARTHANA	15.06.2022	<i>[Signature]</i>	
A6	CHARACTERISTIC CURVE ADDED	RAMYA	04.03.2019	SUJATHA	
A5	MARKING OF TYPE OF FUSE CHANGED FROM 'F' TO 'T'	MADHUSHREE	21.12.2017	SACHIN	
A4	NOTE ADDED	MADHUSHREE	08.11.2017	SACHIN	
A3	BLOWING CHARACTERISTICS REVISED	VENILA	28.11.2015	SACHIN V.RAMANI	
A2	Isqt & 3.5A CURRENT RATING IS INCLUDED	RAVISH.S	27.10.2010		
A1	MARKING INFORMATION IS ADDED & DRAWINGS IS REDRAWN	SAMSON	03.03.2001		
A	ORIGINAL	SAMSON	17.07.1999		
REV.	DESCRIPTION	DRN. BY	DATE	CK'ED BY	APP'D BY

Projection:



Scale: NTS

Sht. Size: A4

Gen. Tol.: $\pm 0.1\text{mm}$
 $\pm 0.2^\circ$

ALL DIMENSIONS ARE IN MM.
IF UNLESS OTHERWISE SPECIFIED.

<http://www.protectron.in>

protectron@protectron.in



PROTECTRON ELECTROMECH (P) LTD

DESCRIPTION : 5.2 X 20, GLASS CARTRIDGE TIME DELAY FUSE,
RoHS

PART NO: PST IN-R

RoHS



SPECIFICATIONS : IEC 60127-2, SHEET-III

RATED VOLTAGE : 250 V

BREAKING CAPACITY : 35 A OR 10 In WHICHEVER IS GREATER,
WHEN TESTED WITH AC CURRENT

MARKINGS ON THE FUSE CAP SHOULD BE AS FOLLOWS:-

TYPE OF FUSE (T), FUSE RATING, RATED VOLTAGE (250V),
BREAKING CAPACITY (L),COMPANY'S IDENTIFICATION,RoHS(R)

MAXIMUM SUSTAINED DISSIPATION AT 1.5 In AFTER 1 HOUR

- i) UPTO AND INCLUDING 2.5A : 1.6W
- ii) 8A & 10A : 4.0W

NOMINAL CURRENT (In)	2.1 In MAX.	2.75 In		4 In		10 In	
		MIN.	MAX.	MIN.	MAX.	MIN.	MAX.
100mA	2 MINUTES	200 mSec	10 Sec	40 mSec	3 Sec	10 mSec	300 mSec
ABOVE 100mA	2 MINUTES	600 mSec	10 Sec	150 mSec	3 Sec	20 mSec	300 mSec



PROTECTRON ELECTROMECH (P) LTD

DESCRIPTION : 5.2 X 20, GLASS CARTRIDGE TIME DELAY FUSE,
RoHS

PART NO: PST IN-R

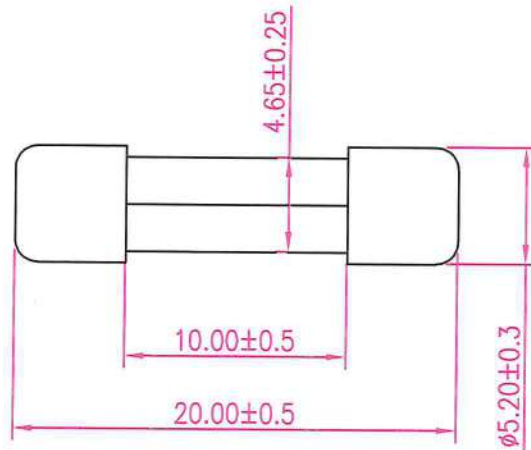

NOMINAL CURRENT RANGE (In)	VOLTAGE DROP DC (mV Max.)	OPERATING I sq t	NOMINAL CURRENT RANGE (In)	VOLTAGE DROP DC (mV Max.)	OPERATING I sq t
32 mA	5000	0.004	2.5 A	120	24
50 mA	3500	0.023	3.0 A	100	---
100 mA	2500	0.075	3.15 A	100	48
125 mA	2000	0.04	3.5 A	100	---
150 mA	1900	0.14	4 A	100	75
160 mA	1900	0.14	5 A	100	115
200 mA	1500	0.14	6 A	100	---
250 mA	1300	0.13	6.3 A	100	220
300 mA	1100	---	7 A	100	---
315 mA	1100	0.35	8 A	100	310
400 mA	1000	0.48	9 A	100	---
500 mA	900	4.9	10 A	100	550
600 mA	300	---	12 A	100	---
630 mA	300	6.1	15 A	100	---
700 mA	250	---	18 A	100	---
750 mA	250	---	20 A	100	3120
800 mA	250	5.3	≥ 22 A	100	---
1 A	150	6.7			
1.25 A	150	8.2			
1.5 A	150	---			
1.6 A	150	11			
2 A	150	20			

REV.	DESCRIPTION	DRN. BY	DATE	CK'ED BY	APP'D BY
A1	DRAWING UPDATED	RAMYA	02.06.2018	<i>[Signature]</i>	<i>[Signature]</i>
A	ORIGINAL	VISHWA.P	11.04.2014		

Projection: 	Scale: NTS	Sht. Size: A4	Gen. Tol.: ± 0.35 mm $\pm 2'$	ALL DIMENSIONS ARE IN MM. IF UNLESS OTHERWISE SPECIFIED.
-----------------	------------	---------------	--------------------------------------	---



PROTECTRON ELECTROMECH (P) LTD

DESCRIPTION : 5.2 x 20, CERAMIC BODY FAST ACTING FUSE

PART NO: PSFC In

APPROVALS:

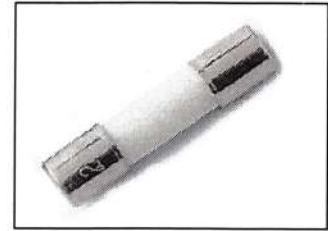

- SPECIFICATIONS** : IEC 60127-2, SHEET-I
- RATED VOLTAGE** : 250 V, AC
- BREAKING CAPACITY** : 35 A OR 10 In WHICHEVER IS GREATER WHEN TESTED WITH AC CURRENT
- CAP** : BRASS, NICKEL PLATED
- BODY** : CERAMIC BODY

MARKINGS ON THE FUSE CAP SHOULD BE AS FOLLOWS:-

TYPE OF FUSE (F), FUSE RATING, RATED VOLTAGE (250V),
BREAKING CAPACITY (L) & COMPANY'S IDENTIFICATION

NOTE:

UL APPROVAL- 100mA TO 6.3A, 8A AND 10A

NOMINAL CURRENT (In)	2.1 In MAX.	2.75 In		4 In		10 In MAX.
		MIN.	MAX.	MIN.	MAX.	
100mA TO 4A	30 MINUTES	10 mSec	2 Sec	3 mSec	300 mSec	20 mSec
>4A TO 6.3A	30 MINUTES	10 mSec	3 Sec	3 mSec	300 mSec	20 mSec
6.3A TO 8.0A	30 MINUTES	40 mSec	20 Sec	10 mSec	1 Sec	30 mSec
8 & 10A	30 MINUTES	40 mSec	20 Sec	10 mSec	1 Sec	40 mSec
10A TO 35A	30 MINUTES	40 mSec	20 Sec	10 mSec	1 Sec	30 mSec



PROTECTRON ELECTROMECH (P) LTD

DESCRIPTION : 5.2 x 20, CERAMIC BODY FAST ACTING FUSE

PART NO: PSFC In

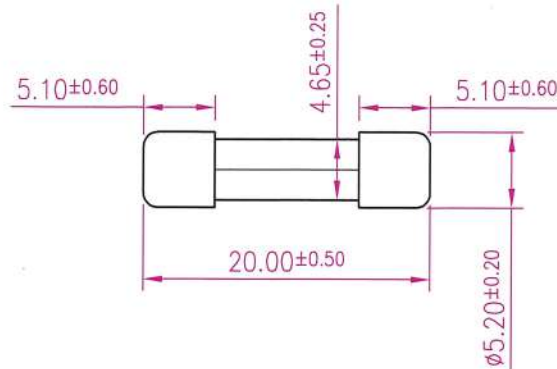

NOMINAL CURRENT RANGE (In)	VOLTAGE DROP DC (mV Max.)	NOMINAL MELTING I ² t (A ² sec)
32 mA	10000	--
40 mA	10000	--
50 mA	10000	--
63 mA	8800	--
80 mA	7600	--
100 mA	7000	--
125 mA	5000	--
150 mA	4300	--
160 mA	4300	--
200 mA	3500	--
250 mA	2800	--
300 mA	2500	--
315 mA	2500	--
350 mA	2000	--
400 mA	2000	--
450 mA	2000	--
500 mA	1800	0.08
600 mA	1500	--
630 mA	1500	0.22
700 mA	1500	--
750 mA	1500	--
800 mA	1200	0.47
1 A	1000	0.84
1.25 A	800	0.92
1.4 A	600	--
1.5 A	600	--
1.6 A	600	0.94
2 A	500	2.70
2.5 A	400	4.0
3 A	350	--
3.15 A	350	8.30
3.5 A	350	--
4 A	300	14.0
4.5 A	250	--
5 A	250	37.0
6 A	200	--
>6.3 A	200	--

TIME-CURRENT CHARACTERISTIC CURVES

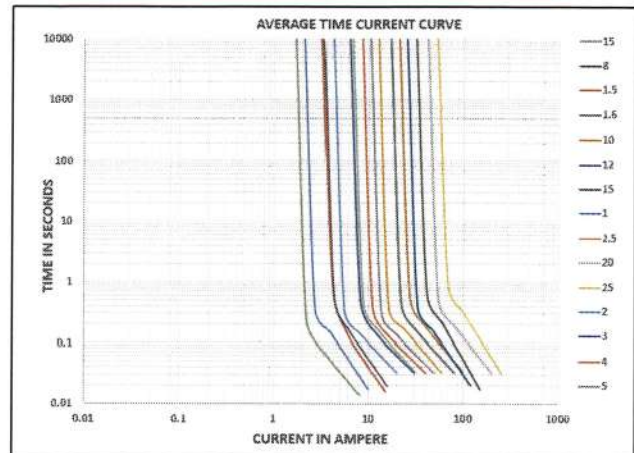

ORDERING INFORMATION

PSFC... mA(In ≤ 800mA) OR
PSFC... A(In ≥ 1A)

REV.	DESCRIPTION	DRN. BY	DATE	CK'ED BY	APP'D BY
A5	TIME-CURRENT CHARACTERISTIC CURVE ADDED	THANUJA	19.04.2021		
A4	DATASHEET REVISED	GEETHA	20.02.2020		
A3	I ² t VALUES ADDED	RAMYA	05.03.2018		
A2	TOLERANCE UPDATED	VENILA	25.04.2015		
A1	RATING EXTENDED TILL 35A	SACHIN	29.01.2004		
A	ORIGINAL	MADHUSHREE	21.07.2018		

Projection:

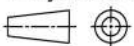

Scale: NTS

Sht. Size: A4

Gen. Tol.: ±0.1mm
±0.2°

ALL DIMENSIONS ARE IN MM.
IF UNLESS OTHERWISE SPECIFIED.



PROTECTRON ELECTROMECH (P) LTD

DESCRIPTION : 5.2 x 20, CERAMIC BODY FAST ACTING FUSE

PART NO: PSFC In-R

APPROVALS:



RoHS



- SPECIFICATIONS** : IEC 60127-2, SHEET-I
- RATED VOLTAGE** : 250 V, AC
- BREAKING CAPACITY** : 35 A OR 10 In WHICHEVER IS GREATER WHEN TESTED WITH AC CURRENT
- CAP** : BRASS, NICKEL PLATED
- BODY** : CERAMIC BODY

MARKINGS ON THE FUSE CAP SHOULD BE AS FOLLOWS:-

TYPE OF FUSE (F), FUSE RATING, RATED VOLTAGE (250V),
BREAKING CAPACITY (H) & COMPANY'S IDENTIFICATION

NOTE:

UL APPROVAL- 100mA TO 6.3A, 8A AND 10A

NOMINAL CURRENT (In)	2.1 In MAX.	2.75 In		4 In		10 In MAX.
		MIN.	MAX.	MIN.	MAX.	
100mA TO 4A	30 MINUTES	10 mSec	2 Sec	3 mSec	300 mSec	20 mSec
>4A TO 6.3A	30 MINUTES	10 mSec	3 Sec	3 mSec	300 mSec	20 mSec
6.3A TO 8.0A	30 MINUTES	40 mSec	20 Sec	10 mSec	1 Sec	30 mSec
8 & 10A	30 MINUTES	40 mSec	20 Sec	10 mSec	1 Sec	40 mSec
10A TO 20A	30 MINUTES	40 mSec	20 Sec	10 mSec	1 Sec	30 mSec



PROTECTRON ELECTROMECH (P) LTD

DESCRIPTION : 5.2 x 20, CERAMIC BODY FAST ACTING FUSE

PART NO: PSFC In-R

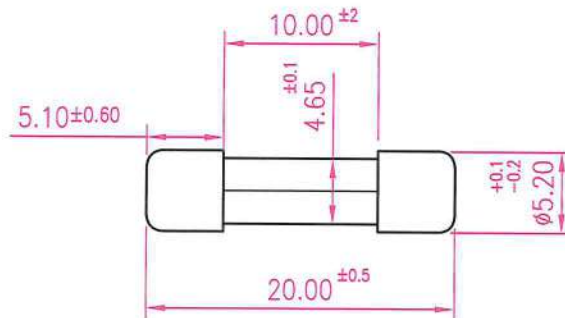

SL.NO	PEPL PART NUMBER	NOMINAL CURRENT RANGE (In)	VOLTAGE DROP DC (mV Max.)
1	PSFC 0.1A-R	100 mA	7000
2	PSFC 0.125A-R	125 mA	5000
3	PSFC 0.15A-R	150 mA	4300
4	PSFC 0.16A-R	160 mA	4300
5	PSFC 0.2A-R	200 mA	3500
6	PSFC 0.25A-R	250 mA	2800
7	PSFC 0.3A-R	300 mA	2500
8	PSFC 0.4A-R	400 mA	2000
9	PSFC 0.5A-R	500 mA	1800
10	PSFC 0.63A-R	630 mA	1500
11	PSFC 0.75A-R	750 mA	1500
12	PSFC 0.8A-R	800 mA	1200
13	PSFC 1A-R	1 A	1000
14	PSFC 1.25A-R	1.25 A	800
15	PSFC 1.4A-R	1.4 A	600
16	PSFC 1.5A-R	1.5 A	600
17	PSFC 1.6A-R	1.6 A	600

SL.NO	PEPL PART NUMBER	NOMINAL CURRENT RANGE (In)	VOLTAGE DROP DC (mV Max.)
18	PSFC 2A-R	2 A	500
19	PSFC 2.5A-R	2.5 A	400
20	PSFC 3A-R	3 A	350
21	PSFC 3.15A-R	3.15 A	350
22	PSFC 4A-R	4 A	300
23	PSFC 5A-R	5 A	250
24	PSFC 6A-R	6 A	200
25	PSFC 6.3A-R	6.3 A	200
26	PSFC 7A-R	7 A	200
27	PSFC 7.5A-R	7.5 A	200
28	PSFC 8A-R	8 A	200
29	PSFC 10A-R	10 A	200
30	PSFC 12A-R	12 A	200
31	PSFC 15A-R	15 A	200
32	PSFC 16A-R	16 A	200
33	PSFC 20A-R	20 A	200

A	ORIGINAL			RAMYA	11.08.2018	<i>M. J. J. J.</i>	<i>Sanjay</i>
REV.	DESCRIPTION			DRN. BY	DATE	CK'ED BY	APP'D BY
Projection: 		Scale: NTS	Sht. Size: A4	Gen. Tol.: ±0.1mm ±0.2	ALL DIMENSIONS ARE IN MM. IF UNLESS OTHERWISE SPECIFIED.		
http://www.protectron.in protectron@protectron.in							



PROTECTRON ELECTROMECH (P) LTD

DESCRIPTION : 5.2 x 20, GLASS CARTRIDGE FAST ACTING FUSE

PART NO: PSF In

APPROVALS:

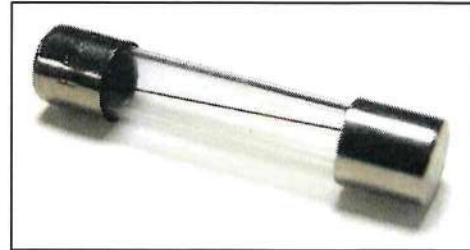

SPECIFICATIONS

: IEC 60127-2, SHEET-II

RATED VOLTAGE

: 250 V

BREAKING CAPACITY

: 35 A OR 10 In WHICHEVER IS GREATER WHEN TESTED WITH AC CURRENT

CAP

: BRASS, NICKEL PLATED

BODY

: GLASS BODY

MARKINGS ON THE FUSE CAP SHOULD BE AS FOLLOWS:-

TYPE OF FUSE (F), FUSE RATING, RATED VOLTAGE (250V), BREAKING CAPACITY (L) & COMPANY'S IDENTIFICATION

NOTE: UL APPROVAL- 100mA TO 6.3A, 8A & 10A

NOMINAL CURRENT (In)	2.1 In MAX.	2.75 In		4 In		10 In MAX.
		MIN.	MAX.	MIN.	MAX.	
100mA	30 MINUTES	10 mSec	500 mSec	3 mSec	100 mSec	20 mSec
>100mA TO 6.3A	30 MINUTES	50 mSec	2 Sec	10 mSec	300 mSec	20 mSec
6.3A TO 8A	30 MINUTES	50 mSec	2 Sec	10 mSec	300 mSec	20 mSec
8 & 10A	30 MINUTES	50 mSec	2 Sec	10 mSec	400 mSec	60 mSec
10A TO 30A	30 MINUTES	50 mSec	2 Sec	10 mSec	400 mSec	40 mSec



PROTECTRON ELECTROMECH (P) LTD

DESCRIPTION : 5.2 x 20, GLASS CARTRIDGE FAST ACTING FUSE

PART NO: PSF In

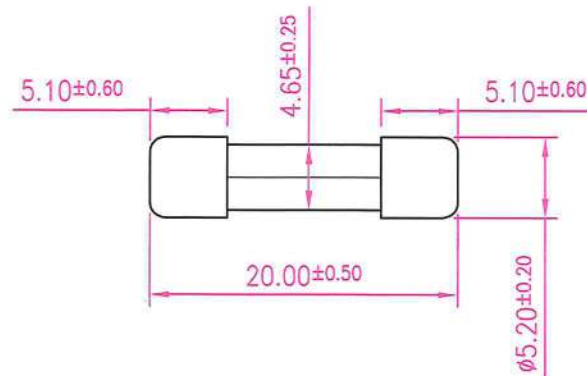

SL.NO	PEPL PART NUMBER	NOMINAL CURRENT RANGE (In)	VOLTAGE DROP DC (mV Max.)	COLD RESISTANCE (mΩ)	OPERATING It A ² Sec
1	PSF 0.1A	100 mA	4000	6.0	0.0023
2	PSF 0.125A	125 mA	3500	-	0.0067
3	PSF 0.15A	150 mA	2000	-	0.018
4	PSF 0.16A	160 mA	2000	-	0.018
5	PSF 0.2A	200 mA	1700	-	0.030
6	PSF 0.25A	250 mA	1400	-	0.021
7	PSF 0.3A	300 mA	1300	-	0.044
8	PSF 0.315A	315 mA	1300	-	0.044
9	PSF 0.4A	400 mA	1200	-	0.088
10	PSF 0.5A	500 mA	1000	274.26	0.15
11	PSF 0.6A	600 mA	650	-	-
12	PSF 0.63A	630 mA	650	-	0.37
13	PSF 0.7A	700 mA	650	-	-
14	PSF 0.75A	750 mA	240	-	-
15	PSF 0.8A	800 mA	240	-	5.3
16	PSF 1A	1 A	200	81.26	5.1
17	PSF 1.25A	1.25 A	200	-	5.6
18	PSF 1.5A	1.5 A	190	-	6.5
19	PSF 1.6A	1.6 A	190	-	6.5
20	PSF 2A	2 A	170	39.35	7.6
21	PSF 2.5A	2.5 A	170	-	9.8

SL.NO	PEPL PART NUMBER	NOMINAL CURRENT RANGE (In)	VOLTAGE DROP DC (mV Max.)	COLD RESISTANCE (mΩ)	OPERATING It A ² Sec
22	PSF 3A	3 A	150	264.30	20
23	PSF 3.15A	3.15 A	150	-	20
24	PSF 3.5A	3.5 A	150	-	-
25	PSF 4A	4 A	130	-	29
26	PSF 4.5A	4.5 A	130	-	-
27	PSF 5A	5 A	130	15.32	38
28	PSF 6A	6 A	130	-	62
29	PSF 6.3A	6.3 A	130	-	62
30	PSF 7A	7 A	130	-	-
31	PSF 7.5A	7.5 A	130	-	-
32	PSF 8A	8 A	130	-	103
33	PSF 9A	9 A	130	-	-
34	PSF 10A	10 A	130	-	184
35	PSF 12A	12 A	130	-	-
36	PSF 15A	15 A	130	-	-
37	PSF 16A	16 A	130	-	-
38	PSF 18A	18 A	130	-	-
39	PSF 20A	20 A	130	-	-
40	PSF 25A	25 A	130	-	-
41	PSF 30A	30 A	130	-	-

ORDERING INFORMATION

PSF... mA(In ≤ 800mA) OR
 PSF... A(In ≥ 1A)

Projection:

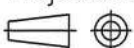

Scale: NTS

Sht. Size: A4

Gen. Tol.: ±0.1mm
±0.2°

ALL DIMENSIONS ARE IN MM.
IF UNLESS OTHERWISE SPECIFIED.

<http://www.protectron.in>

protectron@protectron.in



PROTECTRON ELECTROMECH (P) LTD

DESCRIPTION : 5.2 x 20, GLASS CARTRIDGE FAST ACTING FUSE

PART NO: PSF In

TIME-CURRENT CHARACTERISTIC CURVES

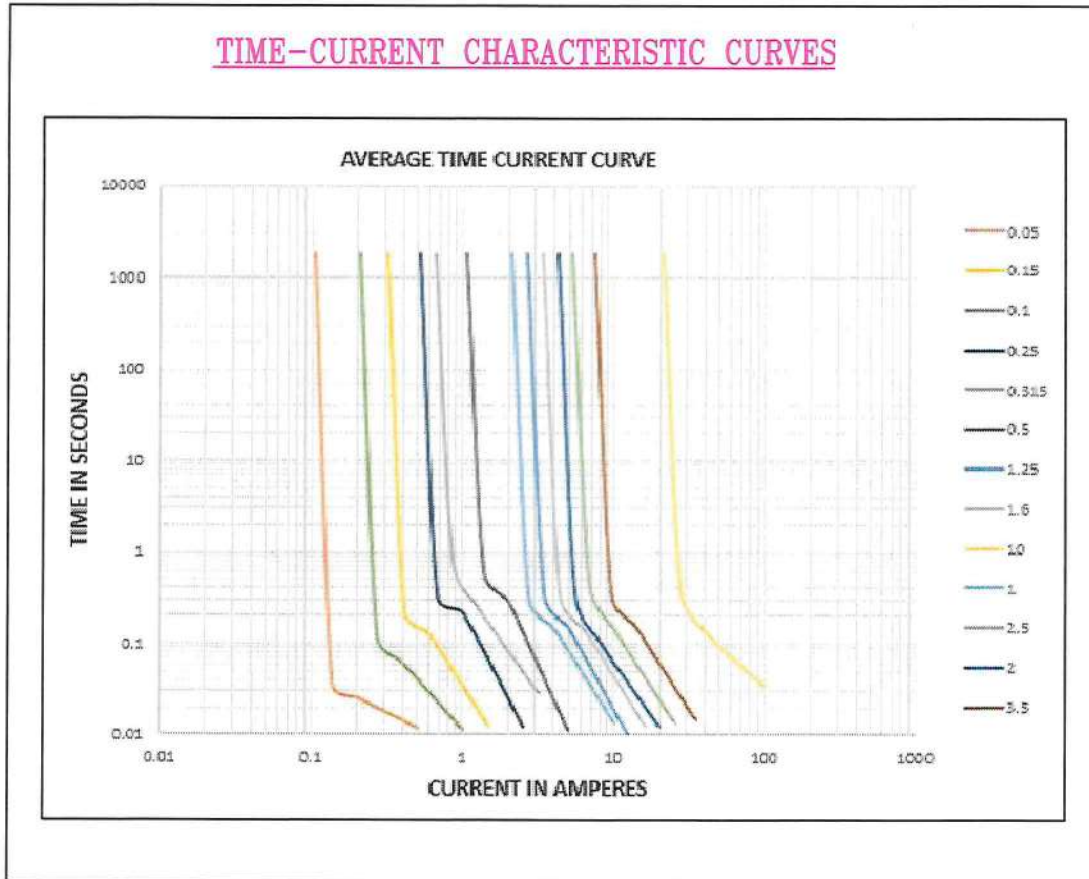

A7	TIME-CURRENT CHARACTERISTIC CURVES ADDED	SWATHI H	18.06.2021	<i>Swathi</i>	<i>Swathi</i>
A6	I ² t VALUES ADDED	GEETHA	13.02.2020		
A5	DATASHEET UPDATED	RAMYA	10.08.2018		
A4	BLOWING CHARACTERISTICS REVISED AS PER IEC	VENILA	28.04.2015		
A3	mV DROP CHANGED	CHAITRA	06.04.2002		
A2	CURRENT RATING ADDED	SAMSON	09.11.2001		
A1	MARKING INFORMATION IS ADDED AND DRAWING IS REDRAWN	SAMSON	03.03.2001		
A	ORIGINAL	SAMSON	17.09.1999		

REV.	DESCRIPTION	DRN. BY	DATE	CK'ED BY	APP'D BY
	Projection:	Scale: NTS	Sht. Size: A4	Gen. Tol.: ±0.1mm ±0.2°	ALL DIMENSIONS ARE IN MM. IF UNLESS OTHERWISE SPECIFIED.



PROTECTRON ELECTROMECH (P) LTD

DESCRIPTION : 5.2x20, GLASS CARTRIDGE FAST ACTING FUSE,
RoHS

PART NO: PSF In-R

RoHS

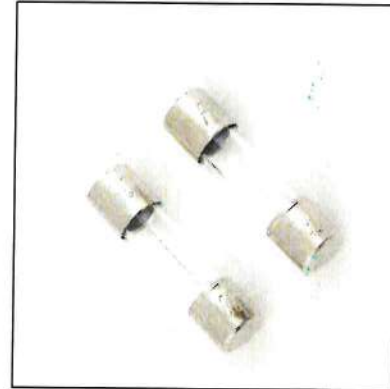

RATED VOLTAGE : 250 V, AC

BREAKING CAPACITY : 35 A OR 10 In WHICHEVER IS GREATER
WHEN TESTED WITH AC CURRENT

MARKINGS ON THE FUSE CAP SHOULD BE AS FOLLOWS:-

TYPE OF FUSE (F), FUSE RATING, RATED VOLTAGE (250V),
RoHS(R), BREAKING CAPACITY (L) & COMPANY'S IDENTIFICATION

NOMINAL CURRENT (In)	2.1 In MAX.	2.75 In		4 In		10 In MAX.
		MIN.	MAX.	MIN.	MAX.	
100mA	30 MINUTES	10 mSec	500 mSec	3 mSec	100 mSec	20 mSec
>100mA TO 6.3A	30 MINUTES	50 mSec	2 Sec	10 mSec	300 mSec	20 mSec
6.3A TO 8A	30 MINUTES	50 mSec	2 Sec	10 mSec	300 mSec	20 mSec
8 & 10A	30 MINUTES	50 mSec	2 Sec	10 mSec	400 mSec	60 mSec
10A TO 30A	30 MINUTES	50 mSec	2 Sec	10 mSec	400 mSec	40 mSec



PROTECTRON ELECTROMECH (P) LTD

DESCRIPTION : 5.2x20, GLASS CARTRIDGE FAST ACTING FUSE,
RoHS

PART NO: PSF In-R

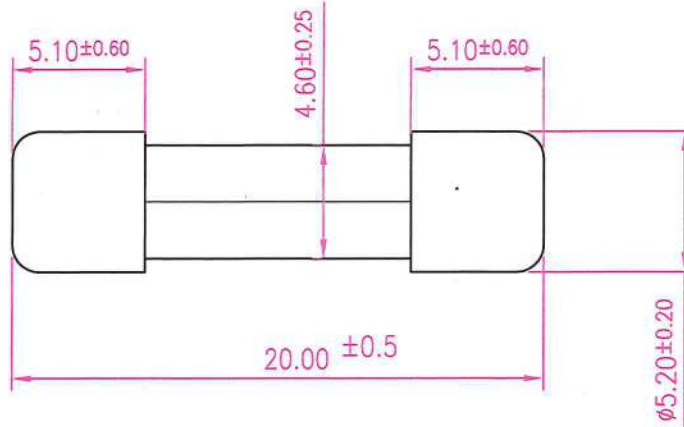

SL.NO	PEPL PART NUMBER	NOMINAL CURRENT RANGE (In)	VOLTAGE DROP DC (mV Max.)	COLD RESISTANCE (mΩ)	OPERATING It A ² Sec
1	PSF 0.1A-R	100 mA	4000	6.0	0.0023
2	PSF 0.125A-R	125 mA	3500	-	0.0067
3	PSF 0.15A-R	150 mA	2000	-	0.018
4	PSF 0.16A-R	160 mA	2000	-	0.018
5	PSF 0.2A-R	200 mA	1700	-	0.030
6	PSF 0.25A-R	250 mA	1400	-	0.021
7	PSF 0.3A-R	300 mA	1300	-	0.044
8	PSF 0.315A-R	315 mA	1300	-	0.044
9	PSF 0.4A-R	400 mA	1200	-	0.088
10	PSF 0.5A-R	500 mA	1000	274.26	0.15
11	PSF 0.6A-R	600 mA	650	-	-
12	PSF 0.63A-R	630 mA	650	-	0.37
13	PSF 0.7A-R	700 mA	650	-	-
14	PSF 0.75A-R	750 mA	240	-	-
15	PSF 0.8A-R	800 mA	240	-	5.3
16	PSF 1A-R	1 A	200	81.26	5.1
17	PSF 1.25A-R	1.25 A	200	-	5.6
18	PSF 1.5A-R	1.5 A	190	-	6.5
19	PSF 1.6A-R	1.6 A	190	-	6.5
20	PSF 2A-R	2 A	170	39.35	7.6
21	PSF 2.5A-R	2.5 A	170	-	9.8

SL.NO	PEPL PART NUMBER	NOMINAL CURRENT RANGE (In)	VOLTAGE DROP DC (mV Max.)	COLD RESISTANCE (mΩ)	OPERATING It A ² Sec
22	PSF 3A-R	3 A	150	264.30	20
23	PSF 3.15A-R	3.15 A	150	-	20
24	PSF 3.5A-R	3.5 A	150	-	-
25	PSF 4A-R	4 A	130	-	29
26	PSF 4.5A-R	4.5 A	130	-	-
27	PSF 5A-R	5 A	130	15.32	38
28	PSF 6A-R	6 A	130	-	62
29	PSF 6.3A-R	6.3 A	130	-	62
30	PSF 7A-R	7 A	130	-	-
31	PSF 7.5A-R	7.5 A	130	-	-
32	PSF 8A-R	8 A	130	-	103
33	PSF 9A-R	9 A	130	-	-
34	PSF 10A-R	10 A	130	-	184
35	PSF 12A-R	12 A	130	-	-
36	PSF 15A-R	15 A	130	-	-
37	PSF 16A-R	16 A	130	-	-
38	PSF 18A-R	18 A	130	-	-
39	PSF 20A-R	20 A	130	-	-
40	PSF 25A-R	25 A	130	-	-
41	PSF 30A-R	30 A	130	-	-

ORDERING INFORMATION

PSF... mA(In ≤ 800mA)-R OR
PSF... A(In ≥ 1A)-R



PROTECTRON ELECTROMECH (P) LTD

DESCRIPTION : 5.2x20, GLASS CARTRIDGE FAST ACTING FUSE,
RoHS

PART NO: PSF In-R

TIME-CURRENT CHARACTERISTIC CURVES

AVERAGE TIME CURRENT CURVE

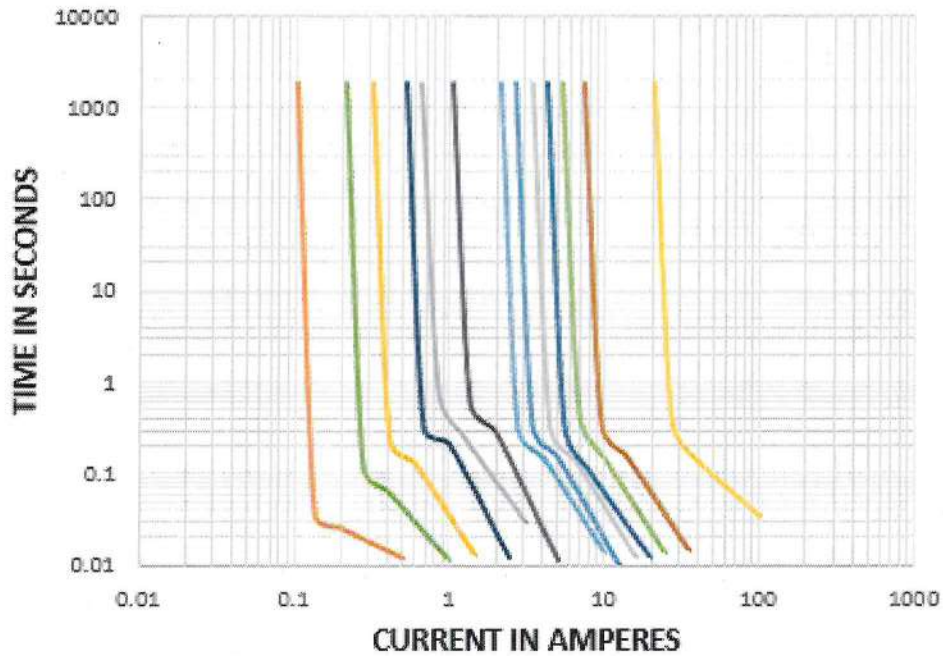

A3	TIME-CURRENT CHARACTERISTICS CURVE ADDED	SOUMYA	09.02.2023	<i>[Signature]</i>
A2	DATASHEET UPDATED UPTO 30A NOMINAL CURRENT RANGE	RAMYA	09.02.2019	
A1	VOLATAGE DROP UPDATED FOR ABOVE 10A	MADHU	21.08.2017	
A	ORIGINAL	ANIL	31.03.2009	

REV.	DESCRIPTION	DRN. BY	DATE	CK'ED BY	APP'D BY
------	-------------	---------	------	----------	----------

Projection:

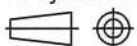

Scale: NTS

Sht. Size: A4

Gen. Tol.: ±0.35mm
±2°

ALL DIMENSIONS ARE IN MM.
IF UNLESS OTHERWISE SPECIFIED.

<http://www.protectron.in>
protectron@protectron.in



PROTECTRON ELECTROMECH (P) LTD

DESCRIPTION : 5 x 20mm, CERAMIC CARTRIDGE TIME DELAY FUSE

PART NO: PSTC In

APPROVALS:



- SPECIFICATIONS** : IEC 60127-2, SHEET-V
- RATED VOLTAGE** : 250 V, AC
- BREAKING CAPACITY** : 1500AMPS, WHEN TESTED WITH AC CURRENT
- CAP** : BRASS, NICKEL PLATED
- BODY** : CERAMIC BODY

MARKINGS ON THE FUSE CAP SHOULD BE AS FOLLOWS:-

TYPE OF FUSE (T), FUSE RATING, RATED VOLTAGE (250V),
BREAKING CAPACITY (H) & COMPANY'S IDENTIFICATION

CERTIFICATIONS:

UL APPROVAL-100mA TO 6.3A, 8A AND 10A

UL CERTIFICATE NUMBER : 20150106-E228912

ADDITIONAL TEST(FOR<10A) AT 1.5In SHALL NOT FUSE WITHIN 1HOUR

NOMINAL CURRENT (In)	2.1 In MAX.	2.75 In		4 In		10 In	
		MIN.	MAX.	MIN.	MAX.	MIN.	MAX.
0.1A TO 0.8A	30 MINUTES	250 mSec	80 Sec	50 mSec	5 Sec	5 mSec	150 mSec
>0.8A TO 3.15A	30 MINUTES	750 mSec	80 Sec	95 mSec	5 Sec	10 mSec	150 mSec
>3.15A	30 MINUTES	750 mSec	80 Sec	150 mSec	5 Sec	10 mSec	150 mSec
8 & 10A	30 MINUTES	750 mSec	80 Sec	150 mSec	5 Sec	10 mSec	150 mSec
>10A	30 MINUTES	1 Sec	80 Sec	150 mSec	5 Sec	20 mSec	100 mSec



PROTECTRON ELECTROMECH (P) LTD

DESCRIPTION : 5 x 20, CERAMIC CARTRIDGE TIME DELAY FUSE

PART NO: PSTC In

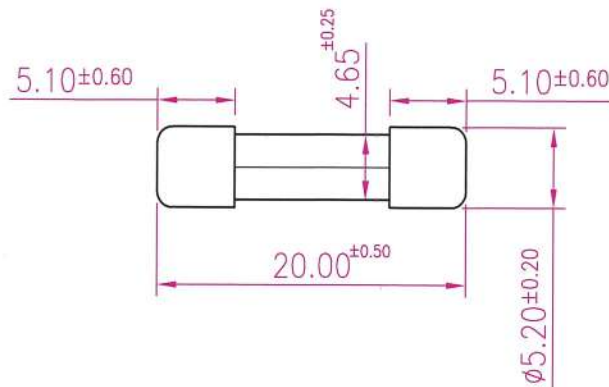

SL.NO	PEPL PART NUMBER	NOMINAL CURRENT RANGE (In)	VOLTAGE DROP DC (mV Max.)
1	PSTC 0.1A	100 mA	2500
2	PSTC 0.125A	125 mA	2000
3	PSTC 0.16A	160 mA	1900
4	PSTC 0.2A	200 mA	1500
5	PSTC 0.25A	250 mA	1300
6	PSTC 0.315A	315 mA	1100
7	PSTC 0.4A	400 mA	1000
8	PSTC 0.5A	500 mA	900
9	PSTC 0.63A	630 mA	300
10	PSTC 0.8A	800 mA	250
11	PSTC 1A	1 A	250
12	PSTC 1.25A	1.25 A	250
13	PST 1.4A	1.4 A	200
14	PST 1.5A	1.5 A	200
15	PST 1.6A	1.6 A	200
16	PSTC 2A	2 A	190
17	PSTC 2.5A	2.5 A	180
18	PSTC 3A	3 A	140
19	PSTC 3.15A	3.15 A	140
20	PSTC 4A	4 A	100
21	PSTC 5A	5 A	100
22	PSTC 6.3A	6.3 A	100
23	PSTC 7A	7 A	100
24	PSTC 8A	8 A	100
25	PSTC 10A	≥10 A	100

TIME-CURRENT CHARACTERISTIC CURVES

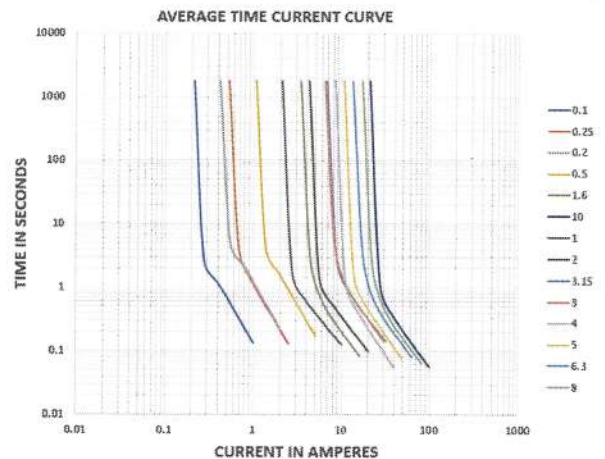

A7	TIME-CURRENT CHARACTERISTIC CURVE ADDED	SWATHI H	19.04.2021	20/4/21	Sathy
A6	TYPE OF FUSE (F) CHANGED TO (T)	THANUJA	24.09.2020		
A5	UL FILE NO INCLUDED	RAMYA	06.06.2019		
A4	BLOWING CHARACTERISTICS REVISED AS PER IEC	VENILA	27.04.2015		
A3	RATING OTHER THAN 1A-7A ADDED	SAVITHA	26.07.2005		
A2	MARKING INFIRMATION IS ADDED AND DRAWING IS REDRAWN	SANDHYA	03.03.2001		
A1	7A FUSE SPEC INCLUDED	SANDHYA	19.09.1999		
A	ORIGINAL	SANDHYA	17.07.1999		

REV.	DESCRIPTION	DRN. BY	DATE	CK'ED BY	APP'D BY
------	-------------	---------	------	----------	----------

Projection:



Scale: NTS

Sht. Size: A4

Gen. Tol.: ±0.1mm
±0.2°

ALL DIMENSIONS ARE IN MM.
IF UNLESS OTHERWISE SPECIFIED.

<http://www.protectron.in>
protectron@protectron.in



PROTECTRON ELECTROMECH (P) LTD

DESCRIPTION : 5 x 20, CERAMIC CARTRIDGE TIME DELAY FUSE
RoHS

PART NO: PSTC In-R



SPECIFICATIONS	:	IEC 60127-2, SHEET-V(1A-6.3A)
RATED VOLTAGE	:	250 V
BREAKING CAPACITY	:	1500AMPS, WHEN TESTED WITH AC CURRENT
CAP	:	BRASS, NICKEL PLATED
BODY	:	CERAMIC BODY

MARKINGS ON THE FUSE CAP SHOULD BE AS FOLLOWS:-

TYPE OF FUSE (F), FUSE RATING, RATED VOLTAGE (250V),
BREAKING CAPACITY (L), RoHS(R) & COMPANY'S IDENTIFICATION

NOMINAL CURRENT (In)	2.1 In MAX.	2.75 In		4 In		10 In	
		MIN.	MAX.	MIN.	MAX.	MIN.	MAX.
0.1A TO 0.8A	30 MINUTES	250 mSec	80 Sec	50 mSec	5 Sec	5 mSec	150 mSec
>0.8A TO 3.15A	30 MINUTES	750 mSec	80 Sec	95 mSec	5 Sec	10 mSec	150 mSec
>3.15A	30 MINUTES	750 mSec	80 Sec	150 mSec	5 Sec	10 mSec	150 mSec
8 & 10A	30 MINUTES	750 mSec	80 Sec	150 mSec	5 Sec	10 mSec	150 mSec
>10A	30 MINUTES	1 Sec	80 Sec	150 mSec	5 Sec	20 mSec	100 mSec



PROTECTRON ELECTROMECH (P) LTD

DESCRIPTION : 5 x 20, CERAMIC CARTRIDGE TIME DELAY FUSE
RoHS

PART NO: PSTC In-R

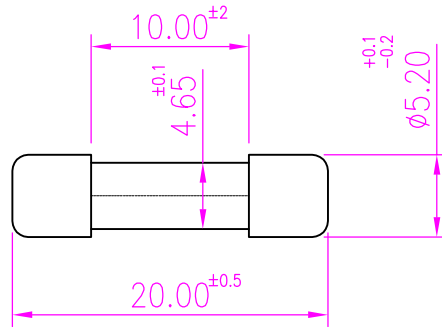

SL.NO	PEPL PART NUMBER	NOMINAL CURRENT RANGE (In)	VOLTAGE DROP DC (mV Max.)
1	PSTC 0.1A-R	100 mA	2500
2	PSTC 0.125A-R	125 mA	2000
3	PSTC 0.16A-R	160 mA	1900
4	PSTC 0.2A-R	200 mA	1500
5	PSTC 0.25A-R	250 mA	1300
6	PSTC 0.315A-R	315 mA	1100
7	PSTC 0.4A-R	400 mA	1000
8	PSTC 0.5A-R	500 mA	900
9	PSTC 0.63A-R	630 mA	300
10	PSTC 0.8A-R	800 mA	250
11	PSTC 1A-R	1 A	250
12	PSTC 1.25A-R	1.25 A	250
13	PST 1.4A-R	1.4 A	200
14	PST 1.5A-R	1.5 A	200
15	PST 1.6A-R	1.6 A	200

SL.NO	PEPL PART NUMBER	NOMINAL CURRENT RANGE (In)	VOLTAGE DROP DC (mV Max.)
16	PSTC 2A-R	2 A	190
17	PSTC 2.5A-R	2.5 A	180
18	PSTC 3A-R	3 A	140
19	PSTC 3.15A-R	3.15 A	140
20	PSTC 4A-R	4 A	100
21	PSTC 5A-R	5 A	100
22	PSTC 6.3A-R	6.3 A	100
23	PSTC 7A-R	7 A	100
24	PSTC 8A-R	8 A	100
25	PSTC 10A-R	10 A	100
26	PSTC 12A-R	12 A	100
27	PSTC 15A-R	15 A	100
28	PSTC 16A-R	16 A	100
29	PSTC 25A-R	25 A	100
30	PSTC 30A-R	30 A	100

A	ORIGINAL		RAMYA	13.08.2018		SACHIN	
REV.	DESCRIPTION			DRN. BY	DATE	CK'ED BY	APP'D BY
Projection: 		Scale: NTS	Sht. Size: A4	Gen. Tol.: ±0.1mm ±0.2°	ALL DIMENSIONS ARE IN MM. IF UNLESS OTHERWISE SPECIFIED.		