



PROTECTRON ELECTROMECH (P) LTD

DESCRIPTION : 5.2 x 20, GLASS CARTRIDGE FAST ACTING FUSE

PART NO: PSF In

APPROVALS:

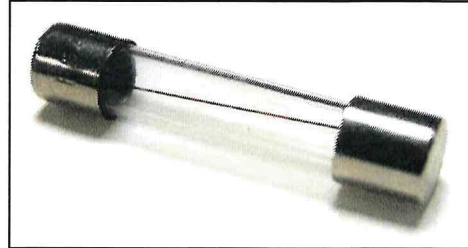

- SPECIFICATIONS** : IEC 60127-2, SHEET-II
- RATED VOLTAGE** : 250 V
- BREAKING CAPACITY** : 35 A OR 10 In WHICHEVER IS GREATER WHEN TESTED WITH AC CURRENT
- CAP** : BRASS, NICKEL PLATED
- BODY** : GLASS BODY

MARKINGS ON THE FUSE CAP SHOULD BE AS FOLLOWS:-

TYPE OF FUSE (F), FUSE RATING, RATED VOLTAGE (250V), BREAKING CAPACITY (L) & COMPANY'S IDENTIFICATION

NOTE: UL APPROVAL- 100mA TO 6.3A, 8A & 10A

NOMINAL CURRENT (In)	2.1 In MAX.	2.75 In		4 In		10 In MAX.
		MIN.	MAX.	MIN.	MAX.	
100mA	30 MINUTES	10 mSec	500 mSec	3 mSec	100 mSec	20 mSec
>100mA TO 6.3A	30 MINUTES	50 mSec	2 Sec	10 mSec	300 mSec	20 mSec
6.3A TO 8A	30 MINUTES	50 mSec	2 Sec	10 mSec	300 mSec	20 mSec
8 & 10A	30 MINUTES	50 mSec	2 Sec	10 mSec	400 mSec	60 mSec
10A TO 30A	30 MINUTES	50 mSec	2 Sec	10 mSec	400 mSec	40 mSec



PROTECTRON ELECTROMECH (P) LTD

DESCRIPTION : 5.2 x 20, GLASS CARTRIDGE FAST ACTING FUSE

PART NO: PSF In

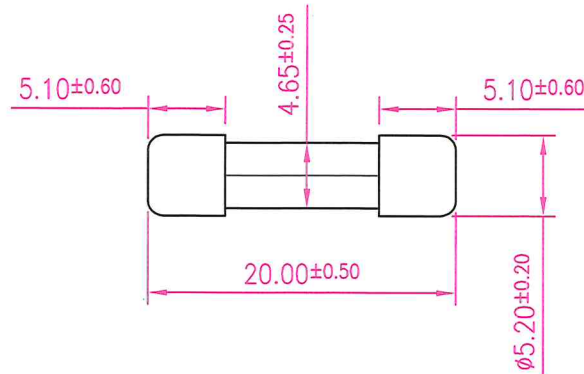

SL.NO	PEPL PART NUMBER	NOMINAL CURRENT RANGE (In)	VOLTAGE DROP DC (mV Max.)	COLD RESISTANCE (mΩ)	OPERATING I ² t A ² Sec
1	PSF 0.1A	100 mA	4000	6.0	0.0023
2	PSF 0.125A	125 mA	3500	-	0.0067
3	PSF 0.15A	150 mA	2000	-	0.018
4	PSF 0.16A	160 mA	2000	-	0.018
5	PSF 0.2A	200 mA	1700	-	0.030
6	PSF 0.25A	250 mA	1400	-	0.021
7	PSF 0.3A	300 mA	1300	-	0.044
8	PSF 0.315A	315 mA	1300	-	0.044
9	PSF 0.4A	400 mA	1200	-	0.088
10	PSF 0.5A	500 mA	1000	274.26	0.15
11	PSF 0.6A	600 mA	650	-	-
12	PSF 0.63A	630 mA	650	-	0.37
13	PSF 0.7A	700 mA	650	-	-
14	PSF 0.75A	750 mA	240	-	-
15	PSF 0.8A	800 mA	240	-	5.3
16	PSF 1A	1 A	200	81.26	5.1
17	PSF 1.25A	1.25 A	200	-	5.6
18	PSF 1.5A	1.5 A	190	-	6.5
19	PSF 1.6A	1.6 A	190	-	6.5
20	PSF 2A	2 A	170	39.35	7.6
21	PSF 2.5A	2.5 A	170	-	9.8

SL.NO	PEPL PART NUMBER	NOMINAL CURRENT RANGE (In)	VOLTAGE DROP DC (mV Max.)	COLD RESISTANCE (mΩ)	OPERATING I ² t A ² Sec
22	PSF 3A	3 A	150	264.30	20
23	PSF 3.15A	3.15 A	150	-	20
24	PSF 3.5A	3.5 A	150	-	-
25	PSF 4A	4 A	130	-	29
26	PSF 4.5A	4.5 A	130	-	-
27	PSF 5A	5 A	130	15.32	38
28	PSF 6A	6 A	130	-	62
29	PSF 6.3A	6.3 A	130	-	62
30	PSF 7A	7 A	130	-	-
31	PSF 7.5A	7.5 A	130	-	-
32	PSF 8A	8 A	130	-	103
33	PSF 9A	9 A	130	-	-
34	PSF 10A	10 A	130	-	184
35	PSF 12A	12 A	130	-	-
36	PSF 15A	15 A	130	-	-
37	PSF 16A	16 A	130	-	-
38	PSF 18A	18 A	130	-	-
39	PSF 20A	20 A	130	-	-
40	PSF 25A	25 A	130	-	-
41	PSF 30A	30 A	130	-	-

ORDERING INFORMATION

PSF... mA(In ≤ 800mA) OR
PSF... A(In ≥ 1A)

Projection:

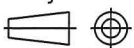

Scale: NTS

Sht. Size: A4

Gen. Tol.: ±0.1mm
±0.2°

ALL DIMENSIONS ARE IN MM.
IF UNLESS OTHERWISE SPECIFIED.

<http://www.protectron.in>

protectron@protectron.in



PROTECTRON ELECTROMECH (P) LTD

DESCRIPTION : 5.2 x 20, GLASS CARTRIDGE FAST ACTING FUSE

PART NO: PSF In

TIME-CURRENT CHARACTERISTIC CURVES

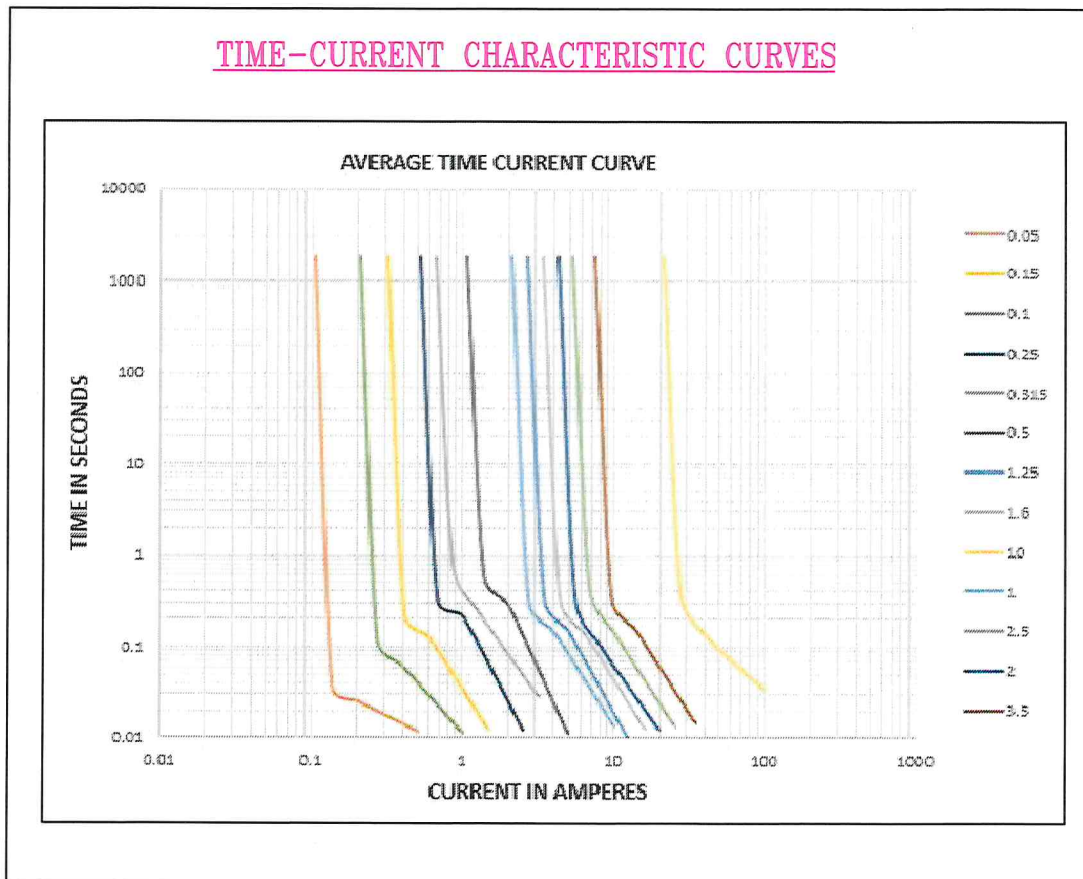

A7	TIME-CURRENT CHARACTERISTIC CURVES ADDED	SWATHI H	18.06.2021	<i>Swathi H</i>	<i>Swathi H</i>
A6	I ² t VALUES ADDED	GEETHA	13.02.2020		
A5	DATASHEET UPDATED	RAMYA	10.08.2018		
A4	BLOWING CHARACTERISTICS REVISED AS PER IEC	VENILA	28.04.2015		
A3	mV DROP CHANGED	CHAITRA	06.04.2002		
A2	CURRENT RATING ADDED	SAMSON	09.11.2001		
A1	MARKING INFORMATION IS ADDED AND DRAWING IS REDRAWN	SAMSON	03.03.2001		
A	ORIGINAL	SAMSON	17.09.1999		

REV.	DESCRIPTION	DRN. BY	DATE	CK'ED BY	APP'D BY
------	-------------	---------	------	----------	----------

Projection: 	Scale: NTS	Sht. Size: A4	Gen. Tol.: ±0.1mm ±0.2°	ALL DIMENSIONS ARE IN MM. IF UNLESS OTHERWISE SPECIFIED.
-----------------	------------	---------------	----------------------------	---