

DESCRIPTION : RADIAL LEAD MICRO FUSES TIME LAG, 300V

PART NO: PMT IN V6

APPROVALS:

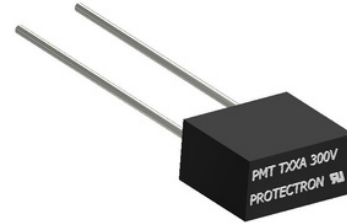

PHYSICAL DATA

MATERIAL

BASE AND CAP	:	PA66, UL 94-V0. BLACK COLOR
ROUND PINS	:	COPPER, TIN PLATED
PACKAGING TYPE		
IN BULK	:	1000 pcs per box
ON TAPE	:	Ammo Pack, 1000pcs box

ELECTRICAL DATA

RATED CURRENT	:	100mA ~ 6.3A
RATED VOLTAGE	:	300V AC
LOADING CAPACITY	:	1.5In FOR 1 HOUR Minimum
INTERRUPT RATING	:	35A or 10 TIMES THE RATED CURRENT WHICHEVER IS GREATER AT 250V AC

MECHANICAL PROPERTIES

TENSILE TEST	:	3Kg
THRUST TEST	:	2N
BENDING TEST	:	NO DAMAGE ARE TO BE VISUALIZED AFTER TWO BENDS OF OPPOSITE DIRECTIONS OF LEAD



DESCRIPTION : RADIAL LEAD MICRO FUSES TIME LAG, 300V

PART NO: PMT IN V6

PULSE TEST :

IN ORDER TO STAND TRANSIENT CURRENT CAUSED BY INDUCTIVE OR CAPACITIVE, THE FUSES ARE DESIGNED TO HAVE MINIMUM CLEARING TIME OF MILLISECOND AT 1000% RATED CURRENT

20msec (100mA ~ 5A)

15msec (6.3A)

ENDURANCE TEST :

LOADING 100% RATED CURRENT, 1HOUR ON, 15 MINUTES OFF. KEEP 100 CYCLES. FOLLOWED BY 1 HOUR AT 1.5 TIMES THE RATED CURRENT.

THE VOLTAGE DROP ACROSS THE FUSE-LINK AFTER THE TEST SHALL NOT HAVE INCREASED BY MORE THAN 10% OF THE ORIGINAL VALUE MEASURED BEFORE THE TEST.

DERATING TEST :

IN AN AIR CIRCULATING OVEN AT 70°C, THE FUSES CAN LOAD 100% RATED CURRENT FOR 1 HOUR AND THEY SHALL NOT OPERATE.

SOLDERING PROCESS PARAMETER :

WAVE SOLDERING

PRE-HEAT TEMPERATURE : 100°C ~ 160°C
PRE-HEAT TIME : 60sec ~ 180sec
SOLDER TEMPERATURE : 260°C Max
DWELL TIME : 2sec ~ 5sec

RE-FLOW SOLDERING

PRE-HEAT TEMPERATURE : 140°C ~ 165°C
PRE-HEAT TIME : 90sec ~ 120sec
PEAK TEMPERATURE : 250°C Max
SOLDERING TIME > 200°C : 30sec

MANUAL SOLDERING

SOLDER IRON TEMPERATURE : 350°C ± 5°C
HEATING TIME : 5sec Max

SALT SPRAY TEST :

MIL-STD-202G, METHOD 101E, TEST CONDITION A
SALT SPRAY CONCENTRATION : 5±1%
TEST LIQUID TEMPERATURE : 35±0.5°C
96hrs, ΔR < 15%



DESCRIPTION : RADIAL LEAD MICRO FUSES TIME LAG, 300V

PART NO: PMT IN V6

SHORT LEADS

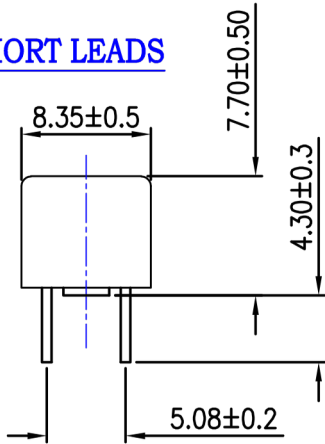

LONG LEADS

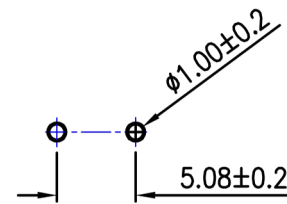
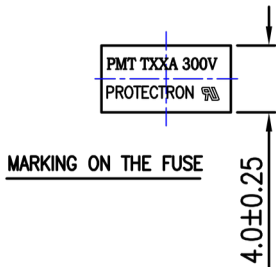
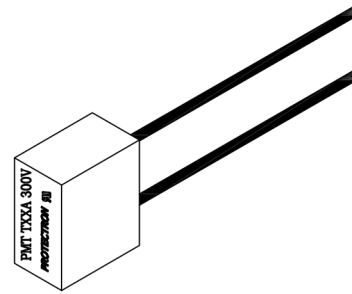
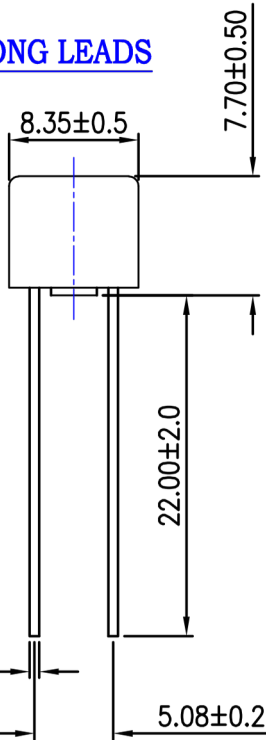

MOUNTING HOLES

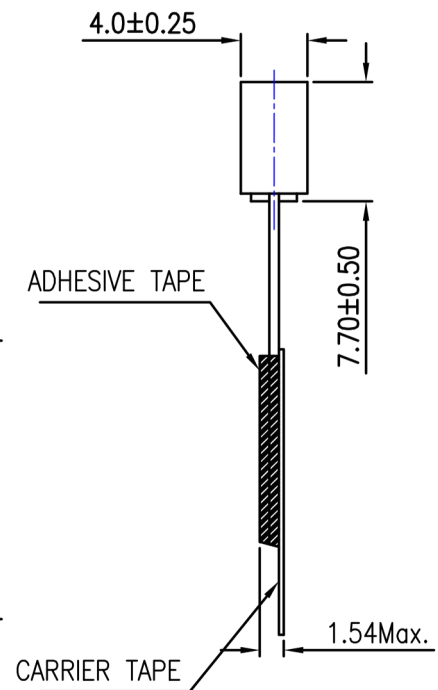
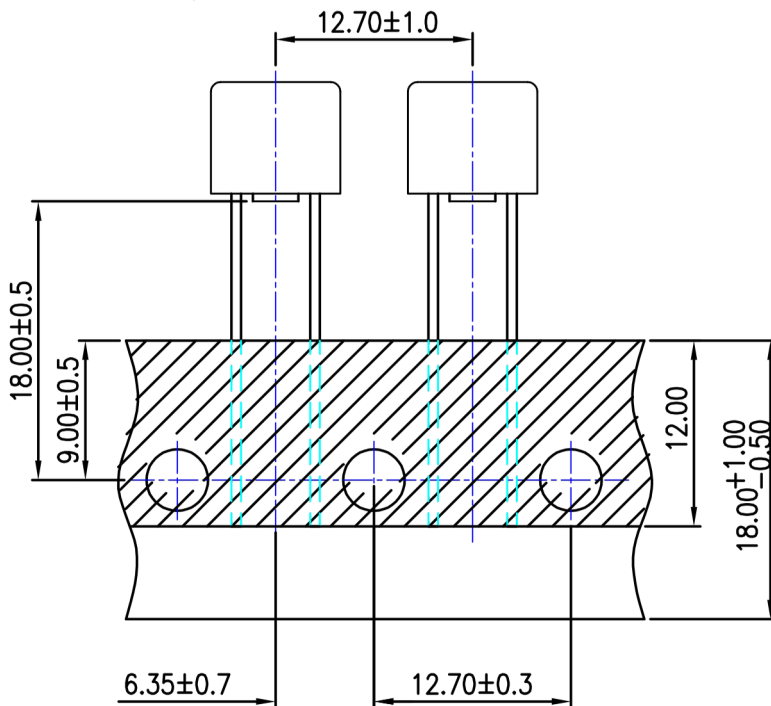

Projection:

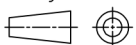

Scale: NTS

Sht. Size: A4

Gen. Tol.: ±0.25mm
±2'

ALL DIMENSIONS ARE IN MM.
IF UNLESS OTHERWISE SPECIFIED.

DESCRIPTION : RADIAL LEAD MICRO FUSES TIME LAG, 300V **PART NO:** PMT IN V6

ELECTRICAL CHARACTERISTIC

RATED CURRENT	1.5 In		2.1 In		2.75 In		4 In		10 In	
	MIN	MAX	MIN	MAX	MIN	MAX	MIN	MAX	MIN	MAX
100mA~5A	60 min	2 min	400 ms	10 sec	150 ms	3 sec	20 ms	150 ms		
6.30A	60 min	2 min	400 ms	10 sec	150 ms	3 sec	15 ms	150 ms		

TIME LAG FUSES TYPE PMT

PROTECTRON PART NUMBERS	Ampere Rating (In)	Voltage Rating (V)	Nominal Melting I ² t A ² Sec
PMT 0.1A V6	100mA	300V	0.0740
PMT 0.125A V6	125mA		0.1090
PMT 0.16A V6	160mA		0.1500
PMT 0.2A V6	200mA		0.2600
PMT 0.25A V6	250mA		0.4700
PMT 0.315A V6	315mA		0.7700
PMT 0.4A V6	400mA		1.2000
PMT 0.5A V6	500mA		1.9500
PMT 0.63A V6	630mA		3.1000
PMT 0.8A V6	800mA		5.1000
PMT 1A V6	1A		10.500
PMT 1.25A V6	1.25A		12.500
PMT 1.6A V6	1.6A		20.000
PMT 2A V6	2A		32.000
PMT 2.5A V6	2.5A		49.000
PMT 3.15A V6	3.15A		78.000
PMT 4A V6	4A		138.00
PMT 5A V6	5A		185.00
PMT 6.3A V6	6.3A		315.00

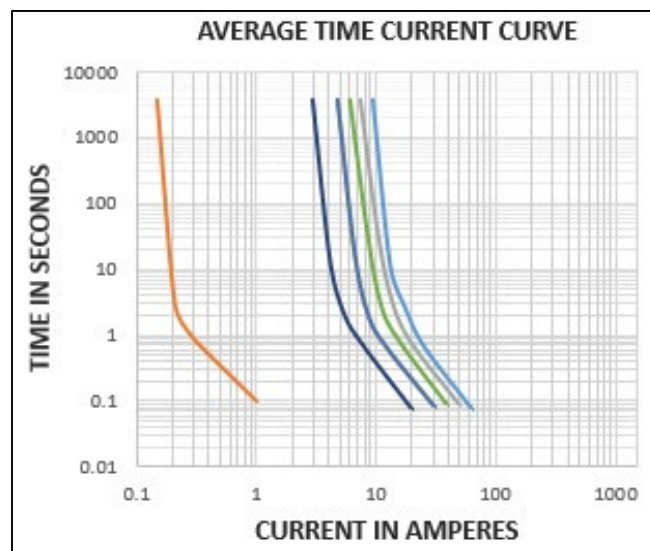

ORDERING INFORMATION

PMT IN V6
 (REFER TABLE)

Projection:



Scale: NTS

Sht. Size: A4

Gen. Tol.: ±0.25mm
±2°

ALL DIMENSIONS ARE IN MM.
IF UNLESS OTHERWISE SPECIFIED.