



**DESCRIPTION :** LP MINI BLADE FUSE HOLDER TO CONNECTOR  
TERMINAL

**PART NO:** PFT 400 IN



RoHS

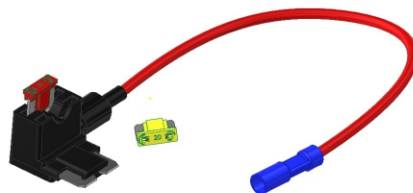

## PHYSICAL DATA

### INSULATION DATA

MATERIAL	:	PA66
FLAMMABILITY	:	UL94V-0
COLOR	:	BLACK COLOUR
TERMINAL	:	COPPER ALLOY, NICKEL PLATED
CONNECTION TERMINAL	:	COPPER ALLOY, NICKEL PLATED + PVC JACKET

## ELECTRICAL DATA

INSULATION RESISTANCE	:	500V DC AT 100M OHMS
DIELECTRIC WITHSTANDING	:	2000V AC/1Min.
RATED VOLTAGE	:	32V
RATED CURRENT	:	FOR 16AWG – 15A FOR 14AWG – 25A FOR 12AWG – 40A

## ENVIRONMENTAL DATA

TEMPERATURE RANGE	:	-10°C TO +85°C
-------------------	---	----------------

## FEATURES

CABLE	:	16AWG CABLE, RED COLOR
-------	---	------------------------



**DESCRIPTION :** LP MINI BLADE FUSE HOLDER TO CONNECTOR  
TERMINAL

**PART NO:** PFT 400 IN

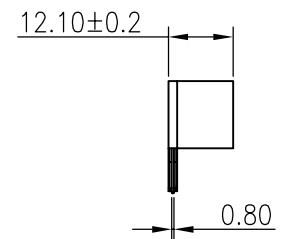
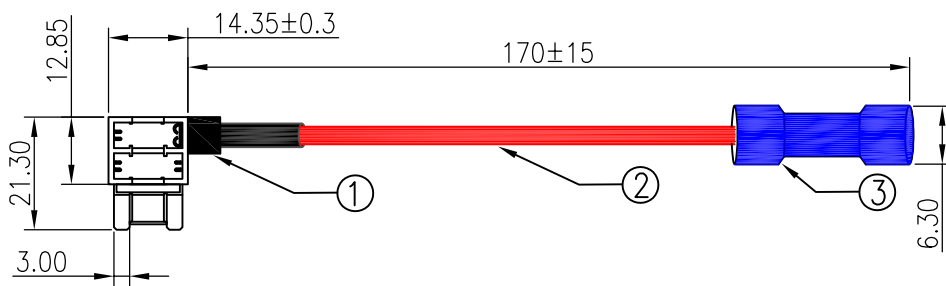
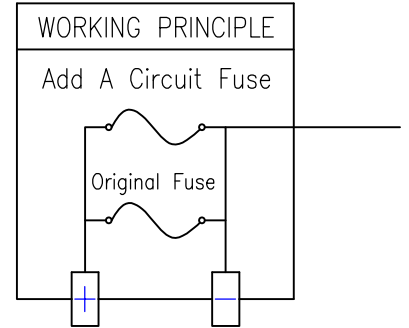

16 AWG CABLE

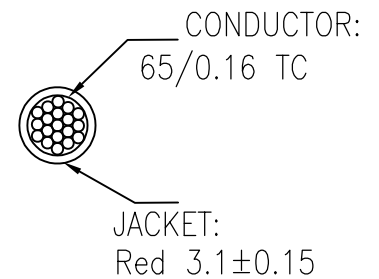

3	TERMINAL : Ø3.0x4.00mm O TYPE, NICKEL PLATED COPPER, BLUE INSULATION
2	16AWG CABLE, COLOR:RED
1	LP MINI BLADE FUSE HOLDER, BLACK
NO.	DESCRIPTION

Projection:

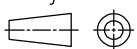

Scale: NTS

Sht. Size: A4

Gen. Tol.:±0.30mm

ALL DIMENSIONS ARE IN MM.  
IF UNLESS OTHERWISE SPECIFIED.