



# PROTECTRON ELECTROMECH (P) LTD

DESCRIPTION : MIDI BOLT DOWN FUSE

PART NO: PBFT-LT-In

RoHS

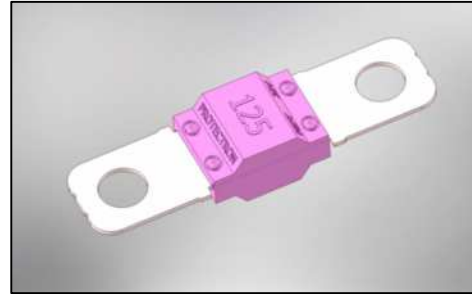

## PHYSICAL DATA

TOP HOUSING : PA6T, UL 94-V2  
BOTTOM HOUSING : PA6T, UL 94-V2  
STRIP : COPPER, Sn PLATED

## ELECTRICAL DATA

RATED VOLT : DC70V  
BREAKING CAPACITY : 2500A

## ENVIRONMENTAL DATA

OPERATING TEMPERATURE : -40°C to +120°C



# PROTECTRON ELECTROMECH (P) LTD

DESCRIPTION : MIDI BOLT DOWN FUSE

PART NO: PBFT-LT-In

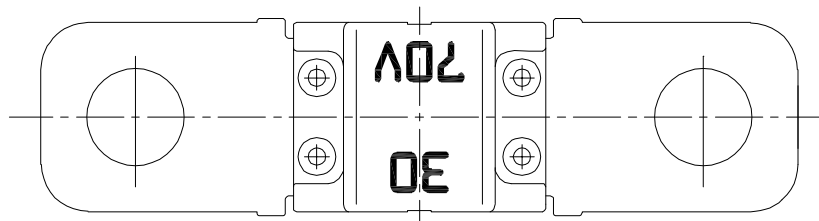
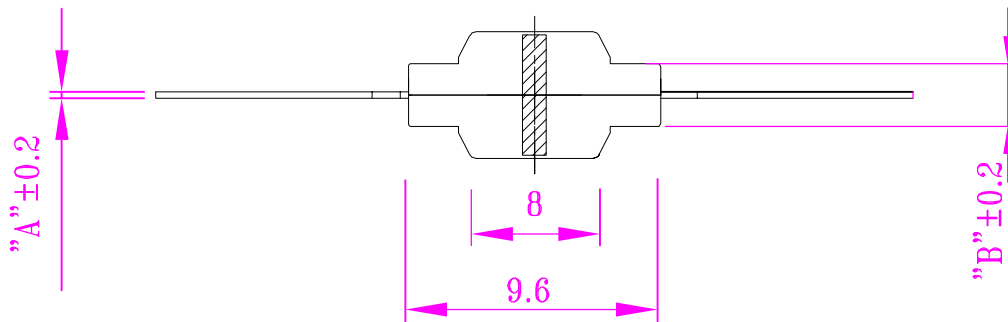
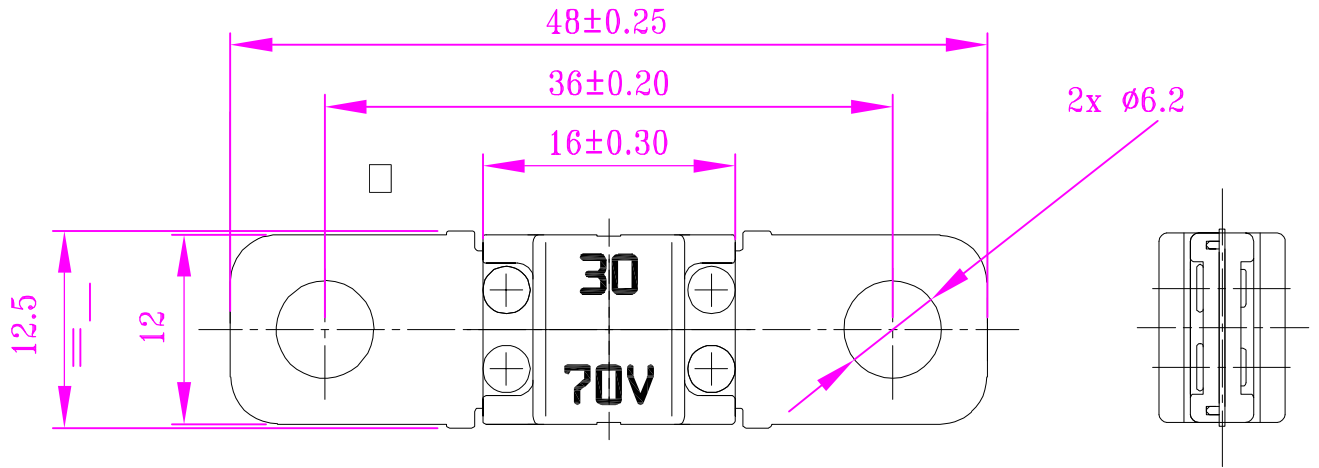

CURRENT RATING	DIMENSIONS	
	A	B
30A-200A	0.60	8



# PROTECTRON ELECTROMECH (P) LTD

DESCRIPTION : MIDI BOLT DOWN FUSE

PART NO: PBFT-LT-In

## TIME-CURRENT CHARACTERISTIC CURVE

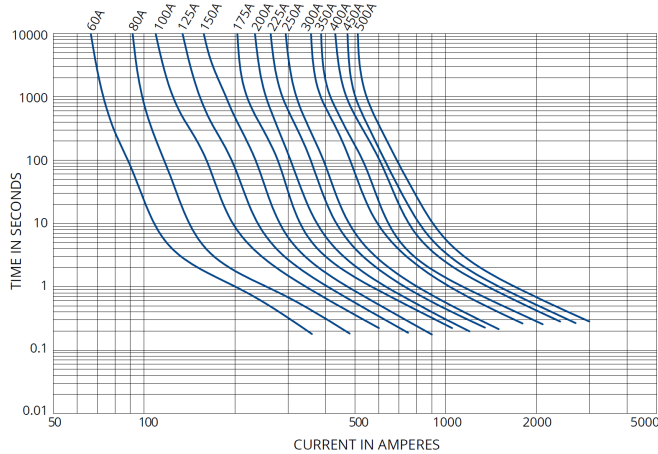

## In-NOMINAL CURRENT RATING

CURRENT RATING	TYP. VOLTAGE DROP	TYP. COLD RESISTANCE
30 A	120 mV	1.03 mΩ
40 A	120 mV	0.75 mΩ
50 A	120 mV	0.55 mΩ
60 A	110 mV	0.43 mΩ
70 A	110 mV	0.36 mΩ
80 A	110 mV	0.30 mΩ
100 A	100 mV	0.80 mΩ
125 A	100 mV	0.23 mΩ
150 A	100 mV	0.22 mΩ
175 A	100 mV	0.17 mΩ
200 A	100 mV	0.15 mΩ

## TIME-CURRENT CHARACTERISTICS [30A-200A]

% of Rating A	OPERATING TIME	
	MIN	MAX
100	100hrs	-/-
135	300 sec	3600sec
150	90 sec	500 sec
200	1 sec	50 sec
300	0.3 sec	4 sec
500	0.1 sec	1 sec
600	0.07 sec	0.7 sec

## ORDERING INFORMATION

**PBFT-LT-In**

(REFER TABLE)

MOQ- AS SPECIFIED

SPQ- AS SPECIFIED

<b>A</b>	<b>ORIGINAL</b>	<b>NITHIN</b>	<b>21.09.2020</b>		
REV.	DESCRIPTION	DRN BY	DATE	CK'ED BY	APP'D BY

Projection: 	Scale: <b>NTS</b>	Sht. Size: <b>A4</b>	Gen. Tol.: ±0.15mm ±2'	ALL DIMENSIONS ARE IN MM. IF UNLESS OTHERWISE SPECIFIED.
-----------------	-------------------	----------------------	---------------------------	---