



**DESCRIPTION:** 6.3 x 32mm, GLASS CARTRIDGE TIME DELAY FUSE **PART NO:** PAT In



**SPECIFICATIONS** : IEC 60127-2  
**RATED VOLTAGE** : 250 V  
**BREAKING CAPACITY** : 35 A OR 10 In WHICHEVER IS GREATER  
WHEN TESTED WITH AC CURRENT  
**OPERATING TEMPERATURE** : -55° TO +125°C  
**CAP** : BRASS, NICKEL PLATED  
**BODY** : GLASS  
**MAXIMUM SUSTAINED DISSIPATION AT 1.5 In AFTER 1 HOUR**

- i) 100mA TO 1A : 1.6W
- i) 1.25A TO 2.5A : 2.5W
- ii) 3.15A TO 10A : 4.0W

**MARKINGS ON THE FUSE CAP SHOULD BE AS FOLLOWS:-**

TYPE OF FUSE (T), FUSE RATING, RATED VOLTAGE (250V), BREAKING CAPACITY (L)  
& COMPANY'S IDENTIFICATION

NOMINAL CURRENT (In)	2.1 In MAX.	2.75 In		4 In		10 In	
		MIN.	MAX.	MIN.	MAX.	MIN.	MAX.
100mA – 30A	120 Sec	200 mSec	10 Sec	100 mSec	3 Sec	20 mSec	300 mSec



**DESCRIPTION:** 6.3 x 32mm, GLASS CARTRIDGE TIME DELAY FUSE **PART NO:** PAT In

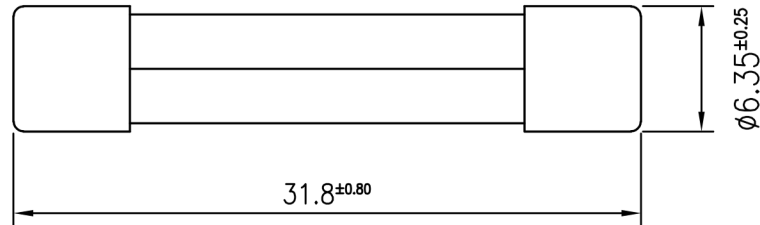

NOTE: FOR MANUAL ASSEMBLY AND OUT SIDE SOLDERING TOTAL LENGTH 31.8±0.80

SL.NO	PEPL PART NUMBER	NOMINAL CURRENT RANGE (In)	VOLTAGE DROP DC (mV Max.)
1	PAT 0.1A	100 mA	2500
2	PAT 0.125A	125 mA	2000
3	PAT 0.15A	150 mA	1700
4	PAT 0.16A	160 mA	1700
5	PAT 0.2A	200 mA	1200
6	PAT 0.25A	250 mA	900
7	PAT 0.3A	300 mA	650
8	PAT 0.315A	315 mA	650
9	PAT 0.35A	350 mA	650
10	PAT 0.4A	400 mA	600
11	PAT 0.5A	500 mA	510
12	PAT 0.6A	600 mA	200
13	PAT 0.63A	630 mA	200
14	PAT 0.8A	800 mA	110
15	PAT 1A	1 A	100
16	PAT 1.25A	1.25 A	100
17	PAT 1.5A	1.5 A	100
18	PAT 1.6A	1.6 A	100
19	PAT 2A	2 A	100
20	PAT 2.5A	2.5 A	100

SL.NO	PEPL PART NUMBER	NOMINAL CURRENT RANGE (In)	VOLTAGE DROP DC (mV Max.)
21	PAT 3A	3 A	100
22	PAT 3.15A	3.15 A	100
23	PAT 3.5A	3.5 A	100
24	PAT 4A	4 A	100
25	PAT 5A	5 A	100
26	PAT 6A	6 A	100
27	PAT 6.3A	6.3 A	100
28	PAT 7A	7 A	100
29	PAT 8A	8 A	100
30	PAT 10A	10 A	100
31	PAT 12A	12 A	100
32	PAT 15A	15 A	100
33	PAT 16A	16 A	100
34	PAT 20A	20 A	100
35	PAT 25A	25 A	100
36	PAT 30A	30 A	100

**ORDERING INFORMATION**

**PAT... mA(In ≤ 800mA) OR  
PAT... A(In ≥ 1A)**

Projection:



Scale: NTS

Sht. Size: A4

Gen. Tol.: ±0.25mm  
±2°

ALL DIMENSIONS ARE IN MM.  
IF UNLESS OTHERWISE SPECIFIED.

DESCRIPTION: 6.3 x 32mm, GLASS CARTRIDGE TIME DELAY FUSE

PART NO: PAT In

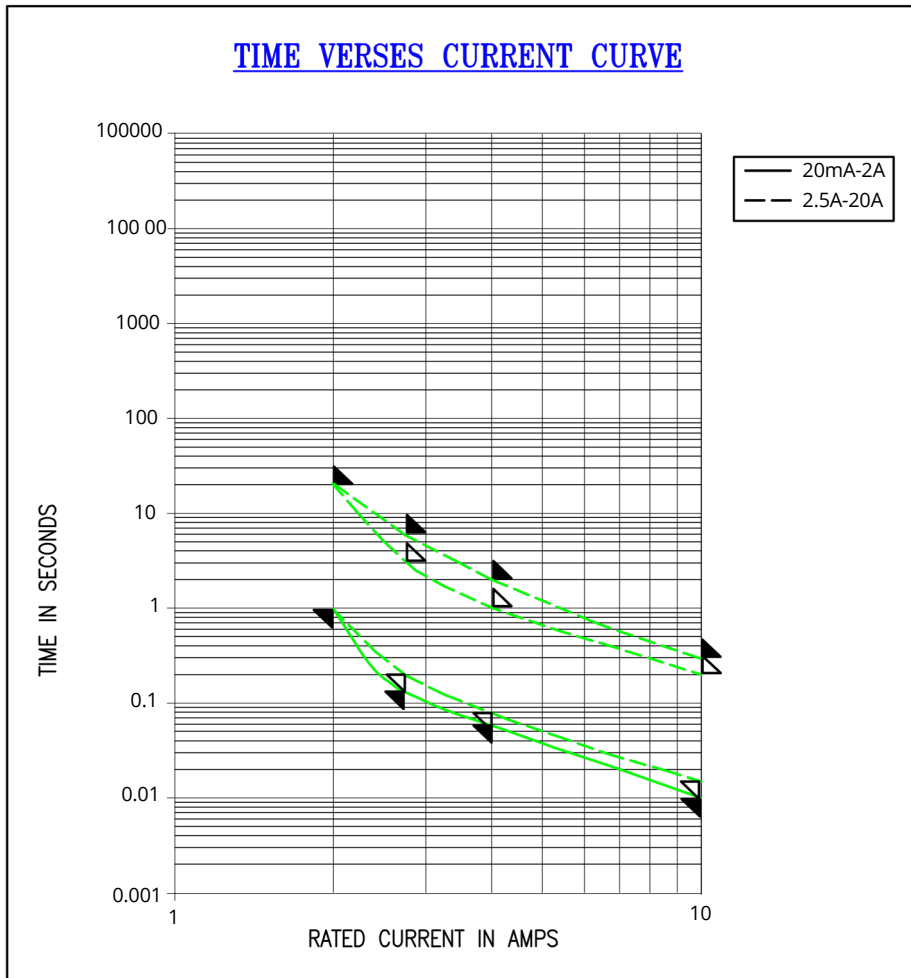

NOTE: HIGHER INTERRUPT RATING FUSES ARE AVAILABLE, PLEASE CONTACT FACTORY FOR THE CUSTOMIZED REQUIREMENT IF ANY

Projection:

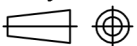

Scale: NTS

Sht. Size: A4

Gen. Tol.:  $\pm 0.25\text{mm}$   
 $\pm 2'$

ALL DIMENSIONS ARE IN MM.  
IF UNLESS OTHERWISE SPECIFIED.