

DESCRIPTION : 1.9mm PITCH MALE CONNECTOR , 4 ROW
 RIGHT ANGLE, RoHS

PART NO: P8094SM-110-1A

RoHS

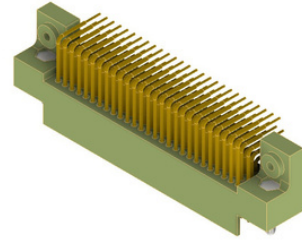

PHYSICAL DATA

INSULATOR BODY : PPS (POLYPHENYLENE SULFIDE FIBREGLASS FILLED THERMOPLASTIC)

FLAMMABILITY : UL94V-0

CONATCT : COPPER ALLOY, NICKEL + 0.25 μ GOLD PLATED

FIXING HARDWARE

GUIDE PINS : STAINLESS STEEL

ELECTRICAL DATA

CONTACTS : 3A MAX.

TEST VOLTAGE : 750V, RMS, 60Hz @ SEA LEVEL AS PER EIA-364-20 METHOD-A
 250V, RMS, 60Hz @ 70,000 FEET AS PER EIA-364-20 METHOD-A

CONTACT RESISTANCE : 0.015 Ω MAX (INTERFACE MEASUREMENT) @ 3AMPS AS PER EIA-364-06

INSULATION RESISTANCE : 5000M Ω MIN @ 500VDC AS PER EIA-364-20.

MECHANICAL DATA

PIN INSERTION FORCE : 0.071Kg

MECHANICAL LIFE CYCLE : 500 CYCLES MIN.

ENVIRONMENTAL DATA

OPERATING TEMPERATURE : -65°C TO +125°C

VIBRATION SEVERITY : MATED CONNECTORS, TEST CONDITION III AS PER EIA-364-28

SHOCK SEVERITY : MATED CONNECTORS, TEST CONDITION G AS PER EIA-364-27

SOLVENT RESISTANCE : HcFc 141 bMGX (ATOChem) SOLVENT

SALT SPRAY TEST : MATED CONNECTORS, TEST CONDITION B AS PER EIA-364-26

HUMIDITY TEST : MATED CONNECTORS TESTED AS PER EIA-364-31, TYPE II
 (EXCEPT STEPS 7A AND 7B)

TEMPERATURE CYCLING : MATED CONDITION, TEST CONDITION A.

SOLDERABILITY : TERMINAL (EXCEPT WIRE WRAP, CRIMP & STACKABLES) TESTED IN
 ACCORDANCE WITH MIL-STD-202, METHOD 208

SIZES 50+ : UPON ENGAGEMENT, CENTER AREA OF MATING FACES MAY REMAIN OPEN
 0.254-0.635mm DUE TO SLIGHT FLEXING OF MOLDING.
 VIBRATION OR SHOCK SHOULD PROVIDE COMPLETE CLOSURE.

DESCRIPTION : 1.9mm PITCH MALE CONNECTOR , 4 ROW
RIGHT ANGLE, RoHS

PART NO: P8094SM-110-1A

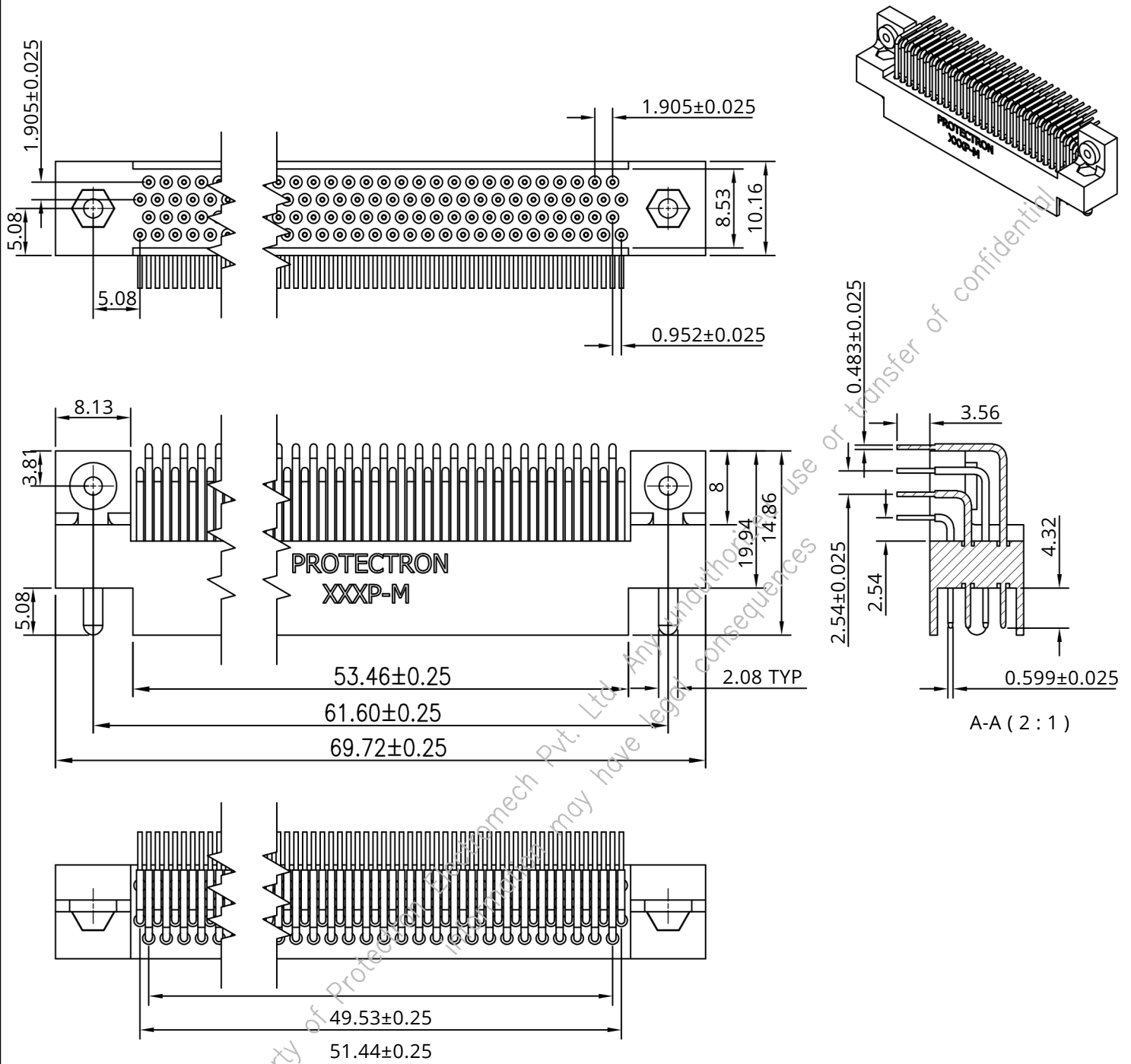

DESCRIPTION : 1.9mm PITCH MALE CONNECTOR , 4 ROW
RIGHT ANGLE, RoHS

PART NO: P8094SM-110-1A

HOLE DIA & PAD DESIGN
CUSTOMER OPTION

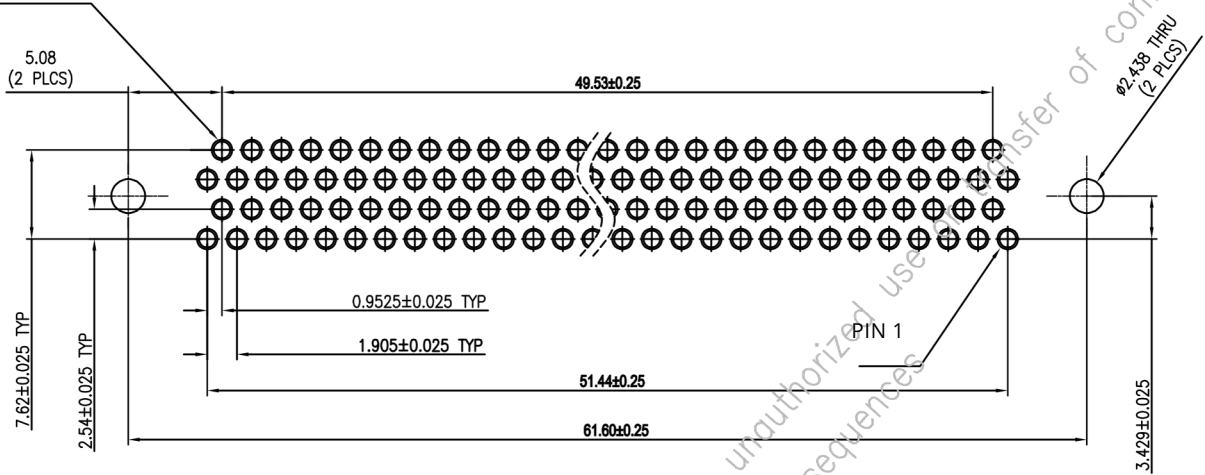

RIGHT ANGLE PTH PLUG
P.C.B LAYOUT VIEWED FROM COMPONENT SIDE

| NO OF CONTACTS | CONTACT ID |
|----------------|------------|
| 110 | |

MATES WITH
P8094FC-110-1A

Projection:

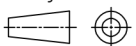

Scale: NTS

Sht. Size: A4

Gen. Tol.: ±0.50mm

ALL DIMENSIONS ARE IN MM.
IF UNLESS OTHERWISE SPECIFIED.