

**DESCRIPTION** : 4 PIN FEMALE CONNECTOR FOR 4.00mm HEIGHT.

**PART NO:** P806JS-04-11A

RoHS

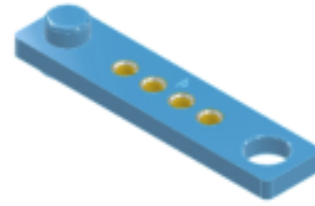

**MATERIAL & FINISH :**

INSULATOR : PPS GF 40%, FR GRADE GRAY/BLACK/BLUE COLOR AS PER MIL-M-24519  
 SLEEVE : BRASS, MINIMUM 4-6μ MATTE TIN PLATED OR HIGHER WITH NICKEL  
 CONTACT CLIP : BERYLLIUM COPPER, MINIMUM 1.25μ GOLD PLATED OR HIGHER WITH NICKEL CLASS 2 AS PER ASTM B 488

**ELECTRICAL DATA:**

CONTACT RESISTANCE : 0.005 OHMS MAX.  
 INSULATION RESISTANCE : 5000 M OHMS .  
 RATED CURRENT : 3A CONTINUOUS.

**MECHANICAL DATA:**

VIBRATION AND SHOCK : WILL BE TESTED AT CUSTOMER END.  
 HUMIDITY : MIL 1344 TEST CONDITION B  
 SALT SPRAY : MIL 1344 TEST CONDITION A  
 INSERTION FORCE : 70 GRAMS/CONTACT MAX.  
 EXTRACTION FROCE : 15 GRAMS/CONTAC MIN.  
 DURABILITY MATING CYCLES : 500 CYCLES, METHOD 2016 OF MIL-STD-1344

OPERATING TEMPERATURE : -20°C TO +85°C  
 STORAGE TEMPERATURE : -30°C TO +100°C

PACKING STD : TUBE OR TRAY PACKING (26PCS/TUBE)





**DESCRIPTION** : 4 PIN FEMALE CONNECTOR FOR 4.00mm HEIGHT.

**PART NO:** P806JS-04-11A

ISOMETRIC VIEW

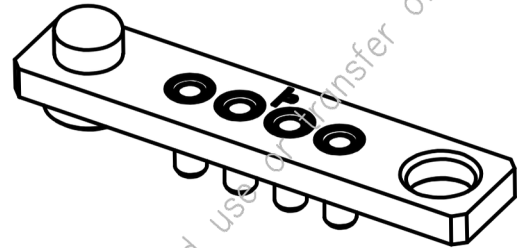

ASSEMBLY WITH MATING CONNECTOR

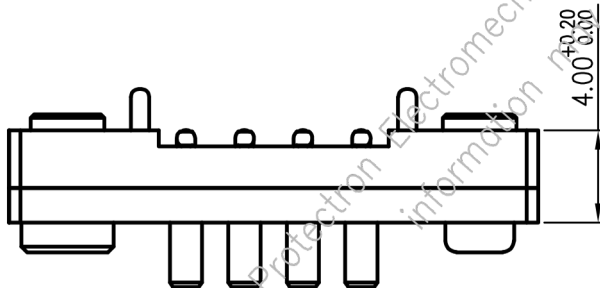

IMPORTANT:

THE STACK UP HEIGHT AFTER MATING THE CONNECTOR I.e SMT AND THROUGH HOLE CONNECTOR SHALL BE AS SHOWN ABOVE

Projection:



Scale: NTS

Sht. Size: A4

Gen. Tol.:  $\pm 0.3\text{mm}$   
 $\pm 2^\circ$

ALL DIMENSIONS ARE IN MM.  
IF UNLESS OTHERWISE SPECIFIED.