



**DESCRIPTION** : DC Terminal for Vehicle Inlet

**PART NO:** P51F40744



**PHYSICAL :**

**MATERIAL** : BRASS (CuZn37Pb3), 3-4 $\mu$  Silver Plating

**ELECTRICAL DATA :**

**RATED CURRENT** : 125A-130A

**MATING CYCLE** : 3000 CYCLE MIN

**OPERATING TEMPERATURE:** -25°C TO +80°C

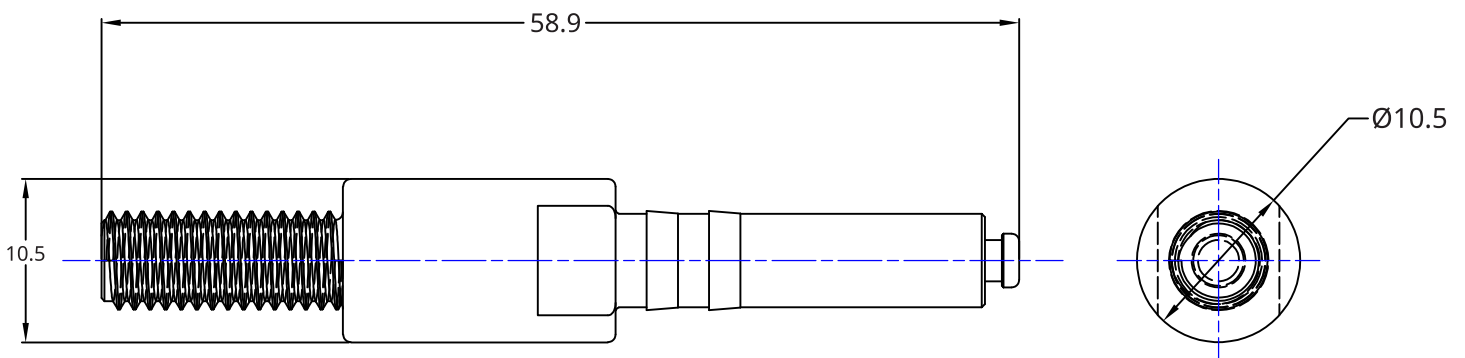

Projection:

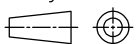

Scale: NTS

Sht. Size: A4

ALL DIMENSIONS ARE IN MM.  
IF UNLESS OTHERWISE SPECIFIED.