

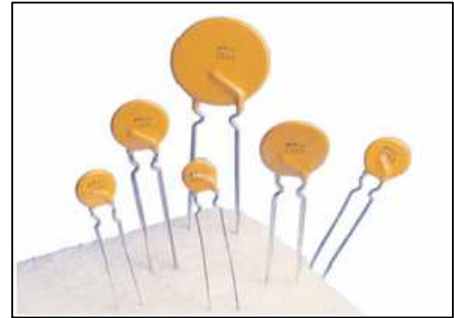

PROTECTRON ELECTROMECH (P) LTD

DESCRIPTION : RADIAL LEADED PTC RESETTABLE FUSE

PART NO: RLDPX SERIES
(REFER TABLE)



1. Summary

- (a) Application: Wide variety of electronic equipments
- (b) Product Features: Low hold current, Solid state, Radial leaded product ideal for up to 60V
- (c) Operation Current: 100mA~3.75A
- (d) Maximum Voltage: 60V
- (e) Temperature Range: -40°C to 85°C

2. Agency Recognition

UL : File NO. E211981
C-UL : File No. E211981
TUV : File No. R50004084

IH= Hold current—maximum current at which the device will not trip at 23°C still air.
IT= Trip current—minimum current at which the device will always trip at 23°C still air.
VMAX= Maximum voltage device can withstand without damage at it's rated current.
IMAX= Maximum fault current device can withstand without damage at rated voltage (V max.).
PD= Typical power dissipated from device when in tripped state in 23°C still air environment.
RMIN= Minimum device resistance at 23°C.
RIMAX= Maximum device resistance at 23°C, 1 hour after tripping.

NOTE : Specification subject to change without notice.



PROTECTRON ELECTROMECH (P) LTD

DESCRIPTION : RADIAL LEADED PTC RESETTABLE FUSE

PART NO: RLDPX SERIES
(REFER TABLE)

3. Electrical Characteristics (23°C)

PART NUMBER	HOLD CURRENT	TRIP CURRENT	MAX. TIME TO TRIP	MAX. CURRENT	RATED VOLTAGE	TYPICAL POWER	RESISTANCE TOLERANCE	
	I _H ,A	I _T ,A	AT5XIH	I _{MAX} ,A	V _{MAX} ,VDC	P _D ,W	R _{min.}	R _{1max.}
							ohms	ohms
RLD60P010X	0.10	0.20	4.0	40	60	0.38	2.50	7.50
RLD60P017X	0.17	0.34	3.0	40	60	0.48	2.00	7.00
RLD60P020X	0.20	0.40	2.2	40	60	0.41	1.83	4.40
RLD60P025X	0.25	0.50	2.5	40	60	0.45	1.25	3.00
RLD60P030X	0.30	0.60	3.0	40	60	0.49	0.88	2.10
RLD60P040X	0.40	0.80	3.80	40	60	0.56	0.55	1.29
RLD60P050X	0.50	1.00	4.0	40	60	0.77	0.50	1.17
RLD60P065X	0.65	1.30	5.3	40	60	0.88	0.31	0.72
RLD60P075X	0.75	1.50	6.3	40	60	0.92	0.25	0.60
RLD60P090X	0.90	1.80	7.2	40	60	0.99	0.20	0.47
RLD60P110X	1.10	2.20	8.2	40	60	1.50	0.15	0.38
RLD60P135X	1.35	2.70	9.6	40	60	1.70	0.12	0.30
RLD60P160X	1.60	3.20	11.4	40	60	1.90	0.09	0.22
RLD60P185X	1.85	3.70	12.6	40	60	2.10	0.08	0.19
RLD60P250X	2.50	5.00	15.6	40	60	2.50	0.05	0.13
RLD60P300X	3.00	6.00	19.8	40	60	2.80	0.04	0.10
RLD60P375X	3.75	7.50	24.0	40	60	3.20	0.03	0.08

4. Thermal Derating Curve :

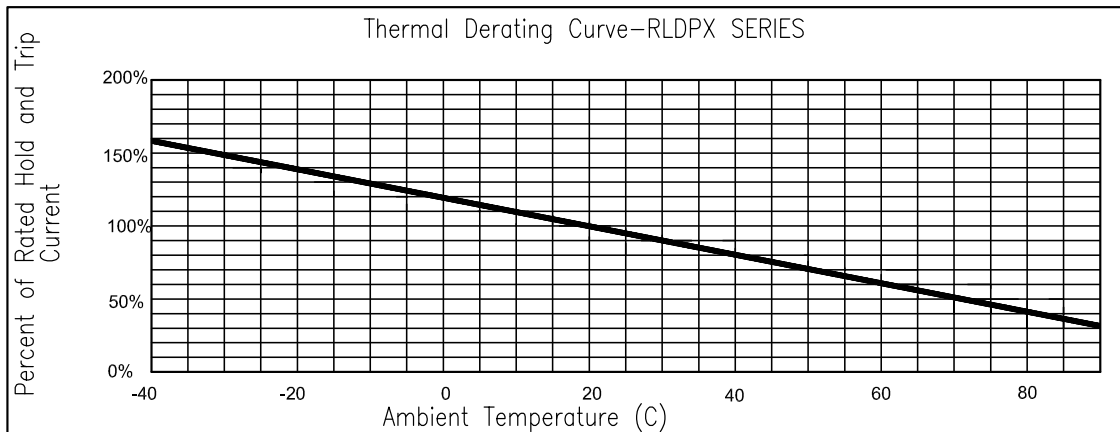

NOTE : Specification subject to change without notice.



PROTECTRON ELECTROMECH (P) LTD

DESCRIPTION : RADIAL LEADED PTC RESETTABLE FUSE

PART NO: RLDPX SERIES
(REFER TABLE)

5. Production Dimensions (millimeter):

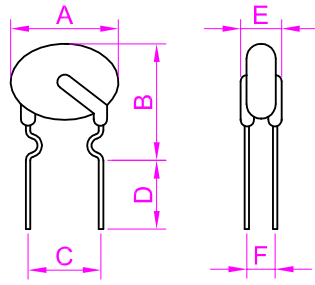

RLD60P010X ~ RLD60P090X
Lead Size : 24AWG
∅ 0.51mm

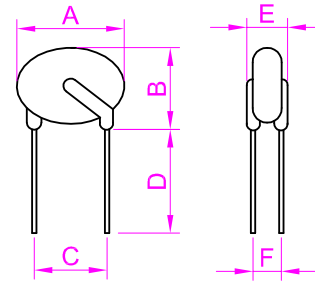

RLD60P110X ~ RLD60P375X
Lead Size : 20AWG
∅ 0.81mm

PART NUMBER	A	B	C	D	E	F
	MAXIMUM	MAXIMUM	TYPICAL	MINIMUM	MAXIMUM	TYPICAL
RLD60P010X	7.4	12.7	5.1	7.6	3.1	1.1
RLD60P017X	7.4	12.7	5.1	7.6	3.1	1.1
RLD60P020X	7.4	12.7	5.1	7.6	3.1	1.1
RLD60P025X	7.4	12.7	5.1	7.6	3.1	1.1
RLD60P030X	7.4	13.0	5.1	7.6	3.1	1.1
RLD60P040X	7.6	13.5	5.1	7.6	3.1	1.1
RLD60P050X	7.9	13.7	5.1	7.6	3.1	1.1
RLD60P065X	9.7	14.5	5.1	7.6	3.1	1.1
RLD60P075X	10.4	15.2	5.1	7.6	3.1	1.1
RLD60P090X	11.7	15.8	5.1	7.6	3.1	1.1
RLD60P110X	13.0	18.0	5.1	7.6	3.1	1.4
RLD60P135X	14.5	19.6	5.1	7.6	3.1	1.4
RLD60P160X	16.3	21.3	5.1	7.6	3.1	1.4
RLD60P185X	17.8	22.9	5.1	7.6	3.1	1.4
RLD60P250X	21.3	26.4	10.2	7.6	3.1	1.4
RLD60P300X	24.9	30.0	10.2	7.6	3.1	1.4
RLD60P375X	28.5	33.5	10.2	7.6	3.1	1.4

NOTE : Specification subject to change without notice.

A	ORIGINAL		SACHIN	06.06.2003		
REV.	DESCRIPTION			DRN. BY	DATE	CK'ED BY APP'D BY
Projection: 		Scale: NTS	Sht. Size: A4	Gen. Tol.: ±0.5mm ±1°	ALL DIMENSIONS ARE IN MM. IF UNLESS OTHERWISE SPECIFIED.	



PROTECTRON ELECTROMECH (P) LTD

DESCRIPTION : RADIAL LEADED PTC RESETTABLE FUSE

PART NO: RLDPX SERIES
(REFER TABLE)

6. Typical Time-To-Trip at 23°C

- A= RLD60P005X
- B= RLD60P010X
- C= RLD60P017X
- D= RLD60P020X
- E= RLD60P025X
- F= RLD60P030X
- G= RLD60P040X
- H= RLD60P050X
- I= RLD60P065X
- J= RLD60P075X
- K= RLD60P090X
- L= RLD60P110X
- M= RLD60P135X
- N= RLD60P160X
- O= RLD60P185X
- P= RLD60P250X
- Q= RLD60P300X
- R= RLD60P375X

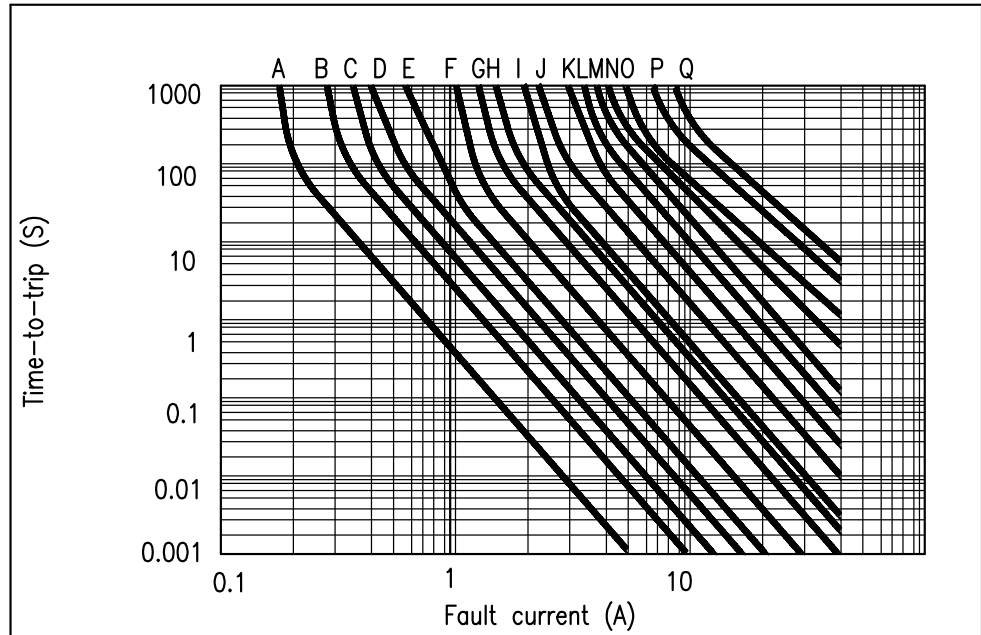

7. Material Specification :

Lead Material : RLD60P010X ~ RLD60P090X Tin plated copper,24 AWG.

RLD60P110X~RLD60P375X Tin plated copper,20 AWG.

Soldering characteristics : MIL-STD-202, Method 208E.

Insulating coating : Flame retardant epoxy, meets UL-94V-0 requirement.

Warning:—Operations beyond the specified maximum ratings or improper use may result in damage and possible electrical arcing and/or flame.



—PPTC device are intended for occasional overcurrent protection. Application for repeated overcurrent condition and/or prolonged trip are not anticipated.

Avoid contact of PPTC device with chemical solvent. Prolonged contact will damage the device performance.

NOTE : Specification subject to change without notice.

ORDERING INFORMATION
RLDPX SERIES
(REFER TABLE)