



PROTECTRON ELECTROMECH (P) LTD

DESCRIPTION : SIM CARD CONNECTOR ASSEMBLY WITH COVER
TYPE

PART NO: PSIMC2-06-CX-6
X=PEG OPTION

RoHS



PHYSICAL

MATERIAL

BODY	:	PPS, UL 94V-0, BLACK COLOUR
COVER	:	LCP, UL 94V-0, BLACK COLOUR
CONTACT	:	SEE TABLE
COLOR	:	BLACK COLOR
PACKAGING TYPE	:	BULK PACKING

ELECTRICAL

CURRENT RATING	:	0.5A
INSULATION RESISTANCE	:	1000M OHMS MIN. AT 500V AC
DIELECTRIC WITHSTANDING	:	500V AC R.M.S FOR ONE MINUTE
CONTACT RESISTANCE	:	30m OHMS MAX

MECHANICAL DATA

MECHANICAL LIFE	:	5000 CYCLES MIN
-----------------	---	-----------------

ENVIRONMENTAL DATA

TEMPERATURE RANGE	:	-25° TO +85° C
-------------------	---	----------------



PROTECTRON ELECTROMECH (P) LTD

DESCRIPTION : SIM CARD CONNECTOR ASSEMBLY WITH COVER
TYPE

PART NO: PSIMC2-06-CX-6
X=PEG OPTION

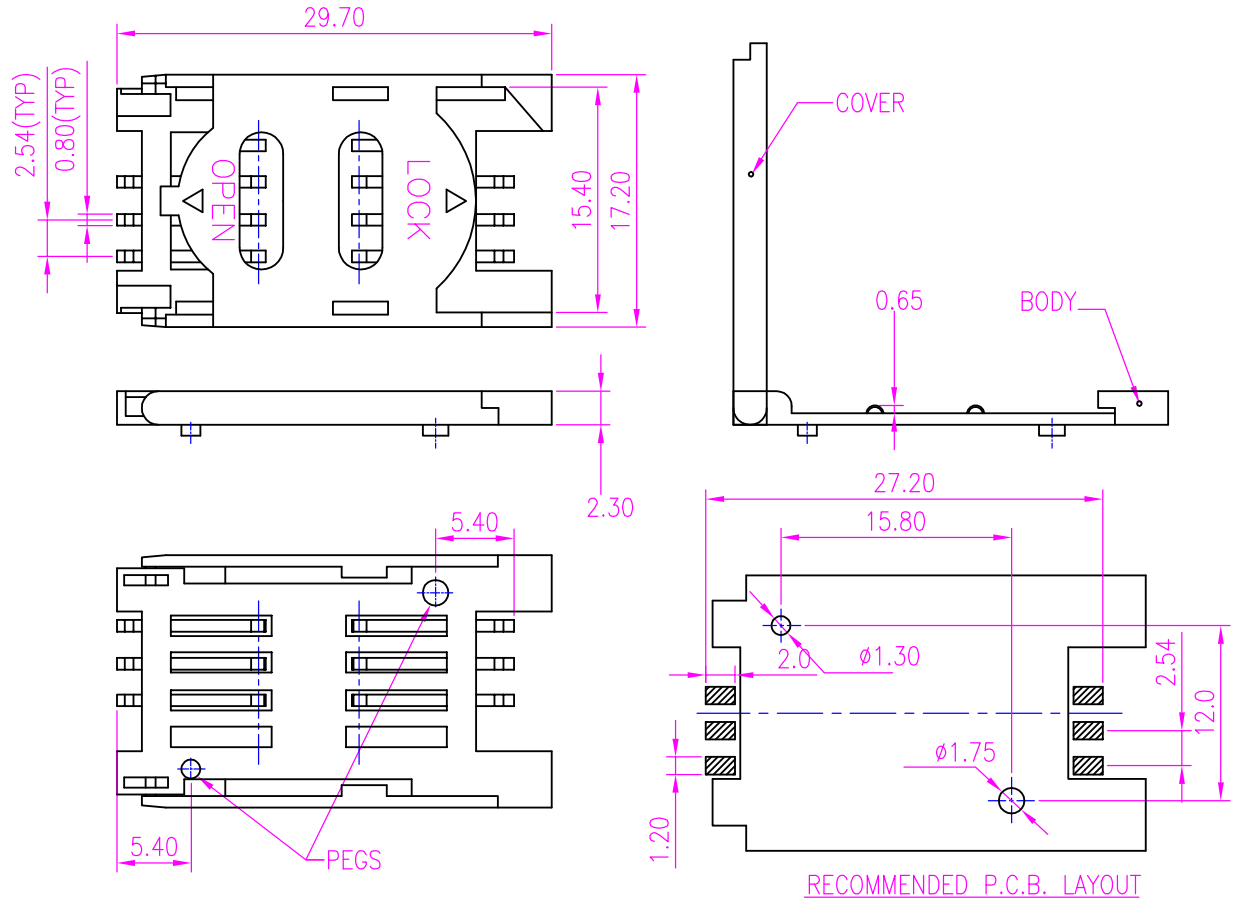

ORDERING INFORMATION

PSIMC2-06-CX-6

NO OF CONTACTS

PEG OPTION:
P=WITH PEG
O=W/O PEG

TYPE OF PLATING:
6=GOLD FLASH ON CONTACT
AREA & TIN ON TAIL

MOQ- ----

SPQ- ----

A1	THE COVER MATERIAL CHANGED FROM PPS TO LCP	CHAITRA	02.04.2008		
A	ORIGINAL	SACHIN	08.05.2004		
REV.	DESCRIPTION	DRN BY	DATE	CK'ED BY	APP'D BY

Projection:

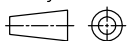

Scale: NTS

Sht. Size: A4

Gen. Tol.: ±0.35mm

ALL DIMENSIONS ARE IN MM.
IF UNLESS OTHERWISE SPECIFIED.

<http://www.protectron.in>

protectron@protectron.in



PROTECTRON ELECTROMECH (P) LTD

DESCRIPTION : SIM CARD CONNECTOR ASSEMBLY WITH COVER
TYPE

PART NO: PSIMC2-08-CX-6
X=PEG OPTION

RoHS



PHYSICAL

MATERIAL

BODY	:	PPS, UL 94V-0, BLACK COLOUR
COVER	:	LCP, UL 94V-0, BLACK COLOUR
CONTACT	:	SEE TABLE
COLOR	:	BLACK COLOR
PACKAGING TYPE	:	BULK PACKING

ELECTRICAL

CURRENT RATING	:	0.5A
INSULATION RESISTANCE	:	1000M OHMS MIN. AT 500V AC
DIELECTRIC WITHSTANDING	:	500V AC R.M.S FOR ONE MINUTE
CONTACT RESISTANCE	:	30m OHMS MAX

MECHANICAL DATA

MECHANICAL LIFE	:	5000 CYCLES MIN
-----------------	---	-----------------

ENVIRONMENTAL DATA

TEMPERATURE RANGE	:	-25° TO +85° C
-------------------	---	----------------



PROTECTRON ELECTROMECH (P) LTD

DESCRIPTION : SIM CARD CONNECTOR ASSEMBLY WITH COVER
TYPE

PART NO: PSIMC2-08-CX-6
X=PEG OPTION

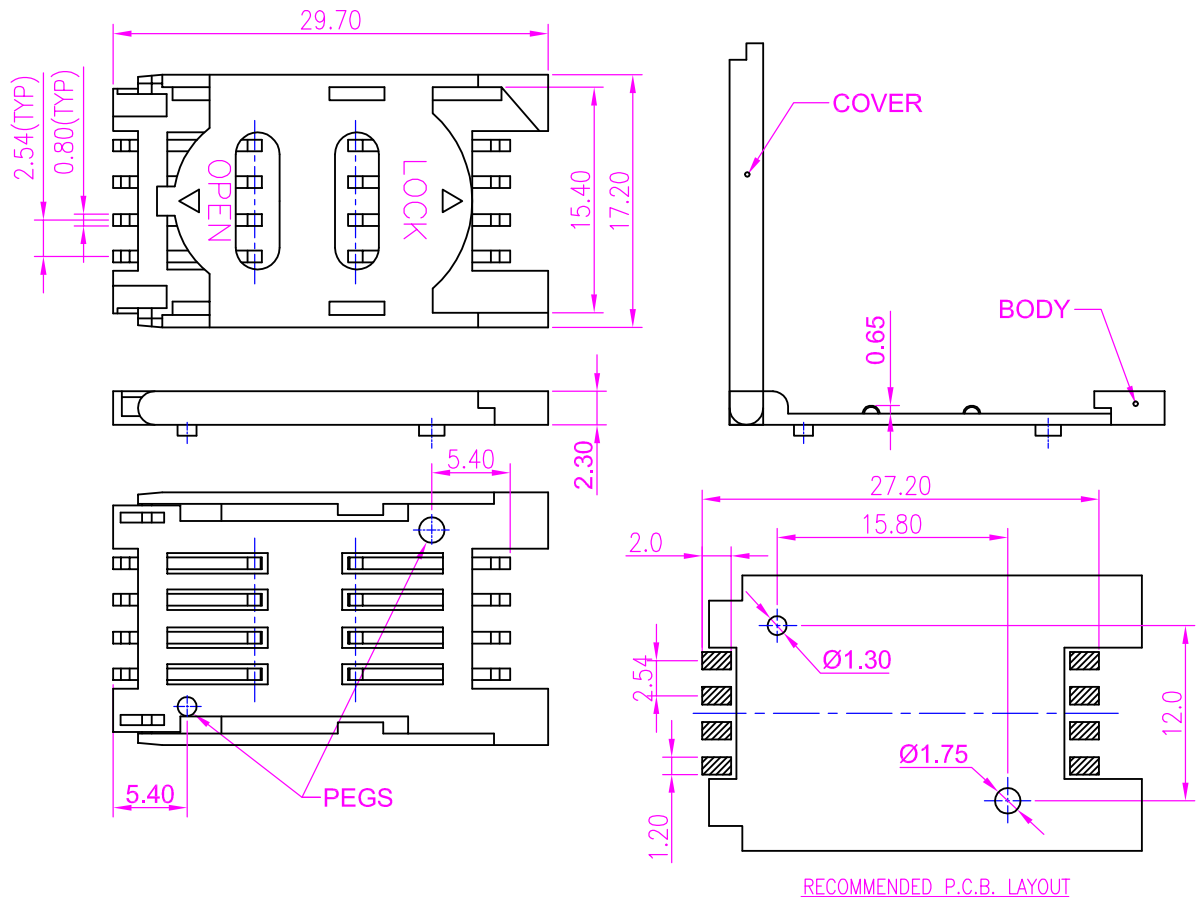

ORDERING INFORMATION

PSIMC2-08-CX-6

NO OF CONTACTS

PEG OPTION:
P=WITH PEG
O=W/O PEG

TYPE OF PLATING:
6=GOLD FLASH ON CONTACT
AREA & TIN ON TAIL

MOQ- ----
SPQ- ----

A1	2.54mm ADDED TO P.C.B LAYOUT AND DISTANCE 5.40mm FROM PEGS TO CONTACT	SACHIN	16.03.2004		
	PIN EDGE IS GIVEN. P/N CHANGED FROM PSIMC-08-CP-6 TO PSIMC2-08-CP/CO-6				
A	ORIGINAL	SACHIN	17.01.2004		
REV.	DESCRIPTION	DRN BY	DATE	CK'ED BY	APP'D BY

Projection:

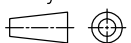

Scale: NTS

Sht. Size: A4

Gen. Tol.: ±0.35mm

ALL DIMENSIONS ARE IN MM.
IF UNLESS OTHERWISE SPECIFIED.