



# PROTECTRON ELECTROMECH (P) LTD

DESCRIPTION : SIM CARD HOLDER, PUSH-PUSH TYPE, 6PIN,  
BLACK COLOR, GOLD PLATED

PART NO:PSIMC16-06-PP-1

RoHS



## PHYSICAL

5	PLASTIC ANCHOR	LCP	1
4	SPRING	STAINLESS STEEL	1
3	CONTACT	PHOSPHOR BRONZE, Au over Ni	6
2	COVER	0.2mmthk STAINLESS STEEL	1
1	HOLDER	LCP	1
No.	DESCRIPTION	MATERIAL	Qty.



# PROTECTRON ELECTROMECH (P) LTD

DESCRIPTION : SIM CARD HOLDER, PUSH-PUSH TYPE, 6PIN,  
BLACK COLOR, GOLD PLATED

PART NO:PSIMC16-06-PP-1

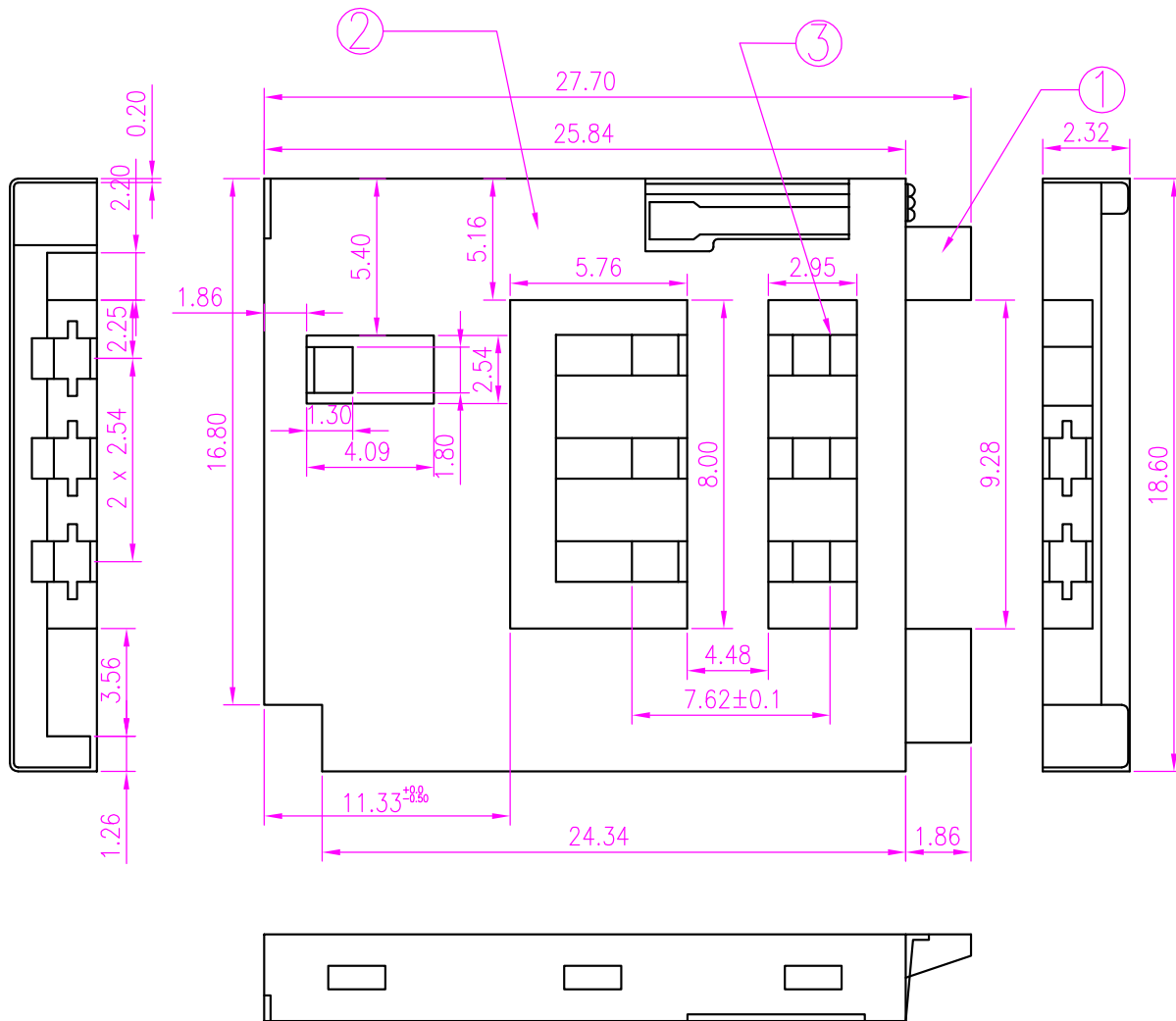

A2	CONTACT NUMBERS UPDATED IN MOUNTING DETAILS	SUJATHA	23.08.2011		
A1	PCB LAYOUT REVISED	ANIL	14.10.2008		
A	ORIGINAL	CHAITRA	17.09.2007		
REV.	DESCRIPTION	DRN BY	DATE	CK'ED BY	APP'D BY

Projection: 	Scale: NTS	Sht. Size: A4	Gen. Tol.: ±0.15mm ±0.2°	ALL DIMENSIONS ARE IN MM. IF UNLESS OTHERWISE SPECIFIED.
-----------------	------------	---------------	-----------------------------	---



# PROTECTRON ELECTROMECH (P) LTD

DESCRIPTION : SIM CARD HOLDER, PUSH-PUSH TYPE, 6PIN,  
BLACK COLOR, GOLD PLATED

PART NO:PSIMC16-06-PP-1

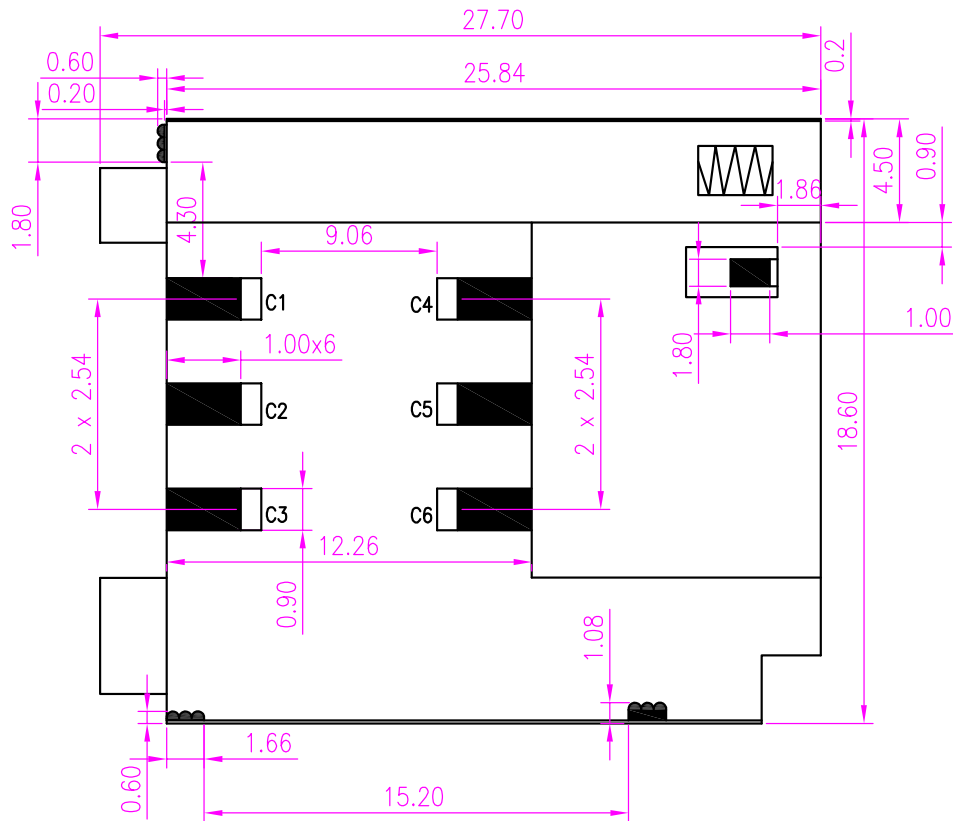

PCB LAYOUT ( BACK SIDE)

NOTE: MOUNTING DIMENSION, SHADOW POINT IS FOR SOLDERING USE

## ORDERING INFORMATION

PSIMC16-06-PP-1

MOQ- ----

SPQ- ----