



# PROTECTRON ELECTROMECH (P) LTD

DESCRIPTION : 1.27X1.27mm PITCH BOX HEADER, DOUBLE ROW  
RIGHT ANGLE

PART NO: P9634SXXX-35-1  
XXX=NO. OF CONTACTS(6-100)

RoHS



## PHYSICAL

### INSULATION

MATERIAL : POLYESTER  
FLAMMABILITY : UL94V-0  
COLOR : BLACK

### CONTACT

MATERIAL : COPPER ALLOY  
SOLDER TAILS : GOLD PLATED  
PACKAGING TYPE : TUBE/TRAY

## ELECTRICAL

CURRENT RATING : 1A  
INSULATION RESISTANCE : 1000M OHMS MIN  
DIELECTRIC WITHSTANDING : 500V AC/MIN  
CONTACT RESISTANCE : 30m OHMS MAX

## ENVIRONMENTAL DATA

TEMPERATURE RANGE : -40°C TO +105°C  
PROCESS RATING : 260°C for 5secs



# PROTECTRON ELECTROMECH (P) LTD

DESCRIPTION : 1.27X1.27mm PITCH BOX HEADER, DOUBLE ROW  
RIGHT ANGLE

PART NO: P9634SXXX-35-1  
XXX=NO. OF CONTACTS(6-100)

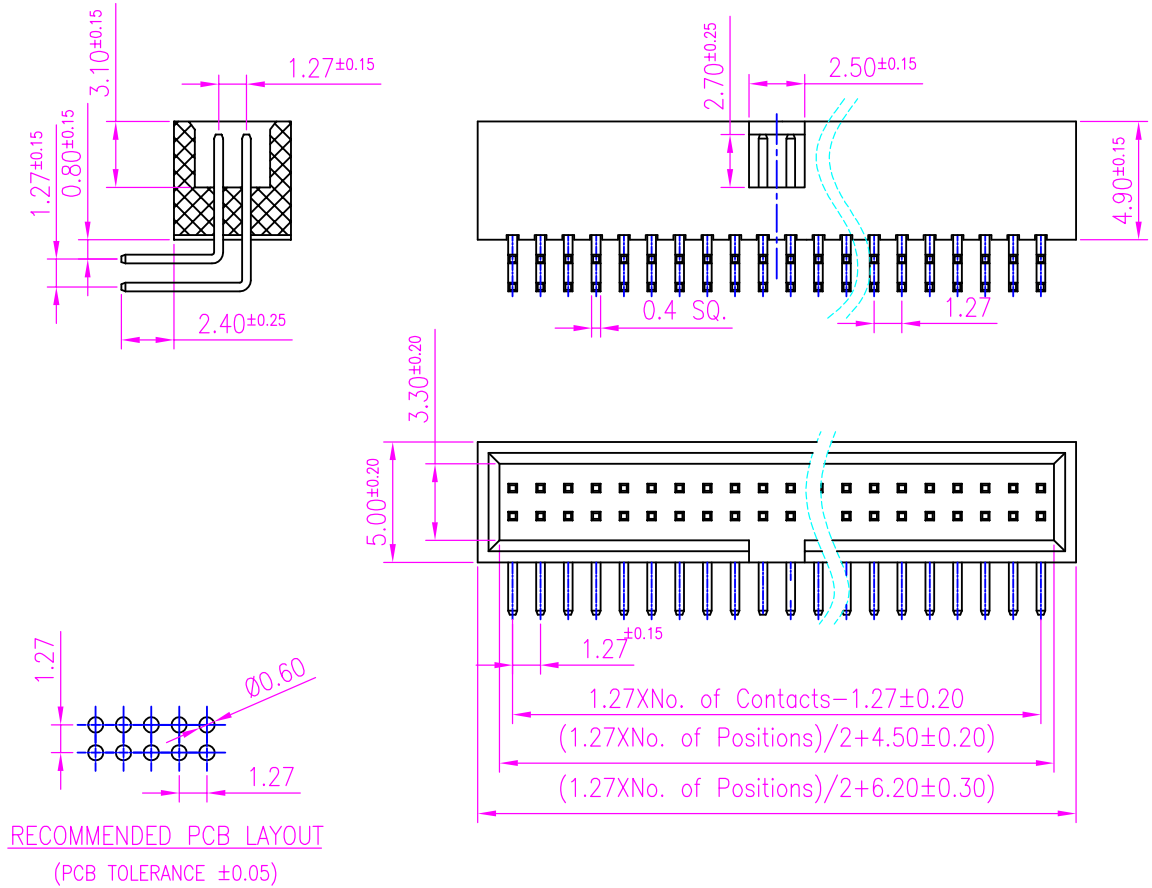

### ORDERING INFORMATION

P9634SXXX-35-1

NO OF CONTACTS  
(6-100)

MATES WITH

P9433IDS  
P9435

MOQ- ----  
SPQ- ----

A	ORIGINAL	ANIL	16.09.2008		
REV.	DESCRIPTION		DRN. BY	DATE	CK'ED BY APP'D BY

Projection:

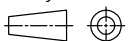

Scale: NTS

Sht. Size: A4

Gen. Tol.: ±0.35mm

ALL DIMENSIONS ARE IN MM.  
IF UNLESS OTHERWISE SPECIFIED.