



PROTECTRON ELECTROMECH (P) LTD

DESCRIPTION : FEMALE HEADER 2.54mm PITCH, SINGLE ROW,
STRAIGHT, 3.55mm PROFILE

PART NO: P94011XX121
1st XX=NO. OF CONTACTS(2-40)

RoHS

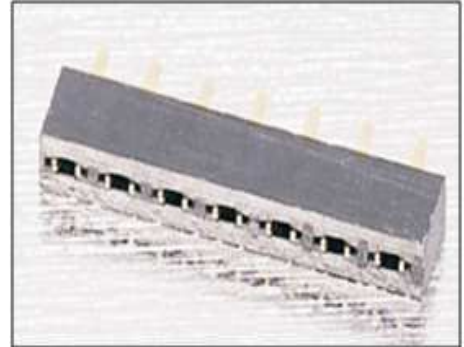

PHYSICAL

INSULATION

MATERIAL	:	PA6T
FLAMMABILITY	:	UL94V-0
COLOR	:	BLACK

CONTACT

MATERIAL	:	PHOSPHOR BRONZE
SOLDER TAILS	:	GOLD PLATED
PACKAGING TYPE	:	TUBE/TRAY

ELECTRICAL

CURRENT RATING	:	3A
INSULATION RESISTANCE	:	1000M OHMS MIN
DIELECTRIC WITHSTANDING	:	500V AC/DC
CONTACT RESISTANCE	:	20m OHMS MAX

ENVIRONMENTAL DATA

TEMPERATURE RANGE	:	-40°C TO +105°C
PROCESS RATING	:	180°C FOR 5SEC



PROTECTRON ELECTROMECH (P) LTD

DESCRIPTION : FEMALE HEADER 2.54mm PITCH, SINGLE ROW,
STRAIGHT, 3.55mm PROFILE

PART NO: P94011XX121
1st XX=NO. OF CONTACTS(2-40)

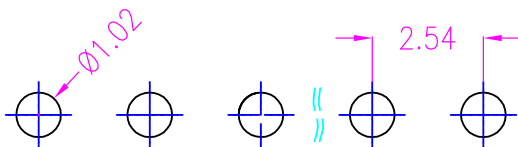
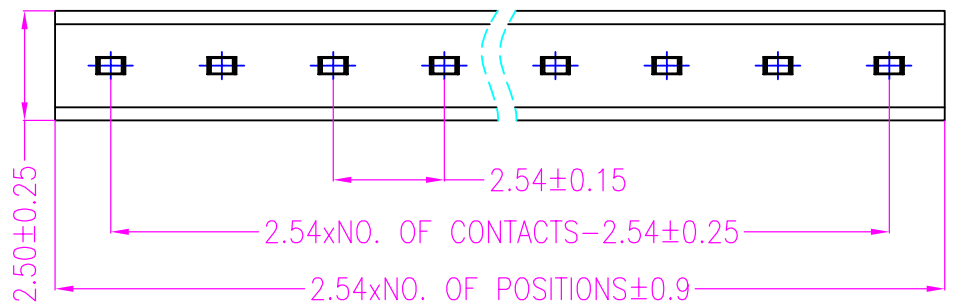
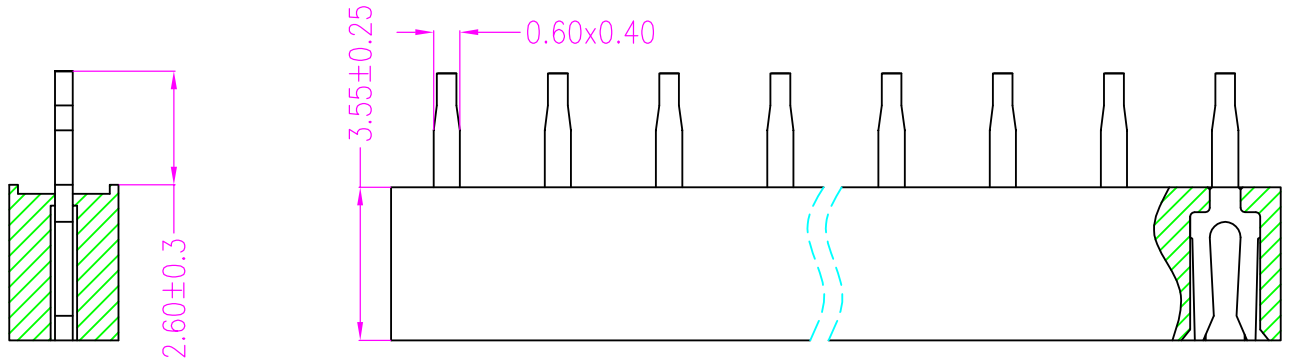

RECOMMENDED PCB LAYOUT
(PCB TOLERANCE ± 0.05)

MATES WITH

P9101, P9102
P9107, P9109

ORDERING INFORMATION

P94011XX121

NO OF CONTACTS
(2-40)

MOQ- ----

SPQ- ----

REV.	A ORIGINAL	DESCRIPTION	RAJESH	10.12.2011	CK'ED BY	APP'D BY
------	------------	-------------	--------	------------	----------	----------

Projection:

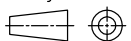

Scale: NTS

Sht. Size: A4

Gen. Tol.: ± 0.2 mm
 $\pm 0.2^\circ$

ALL DIMENSIONS ARE IN MM.
IF UNLESS OTHERWISE SPECIFIED.