



PROTECTRON ELECTROMECH (P) LTD

DESCRIPTION : PIN HEADER 1.27mm PITCH, SINGLE ROW,
RIGHT ANGLE

PART NO: P9132-XXX36-1
XXX=NO. OF CONTACTS(02-40)

RoHS



PHYSICAL

INSULATION

MATERIAL : POLYESTER
FLAMMABILITY : UL94V-0
COLOR : BLACK

CONTACT

MATERIAL : COPPER ALLOY
SOLDER TAILS : GOLD PLATED
PACKAGING TYPE : TUBE/TRAY

ELECTRICAL

CURRENT RATING : 1A
INSULATION RESISTANCE : 5000M OHMS MIN
DIELECTRIC WITHSTANDING : 500V AC/MIN

ENVIRONMENTAL DATA

TEMPERATURE RANGE : -40°C TO +105°C
PROCESS RATING : 180°C FOR 5SEC



PROTECTRON ELECTROMECH (P) LTD

DESCRIPTION : PIN HEADER 1.27mm PITCH, SINGLE ROW,
RIGHT ANGLE

PART NO: P9132-XXX36-1
XXX=NO. OF CONTACTS(02-40)

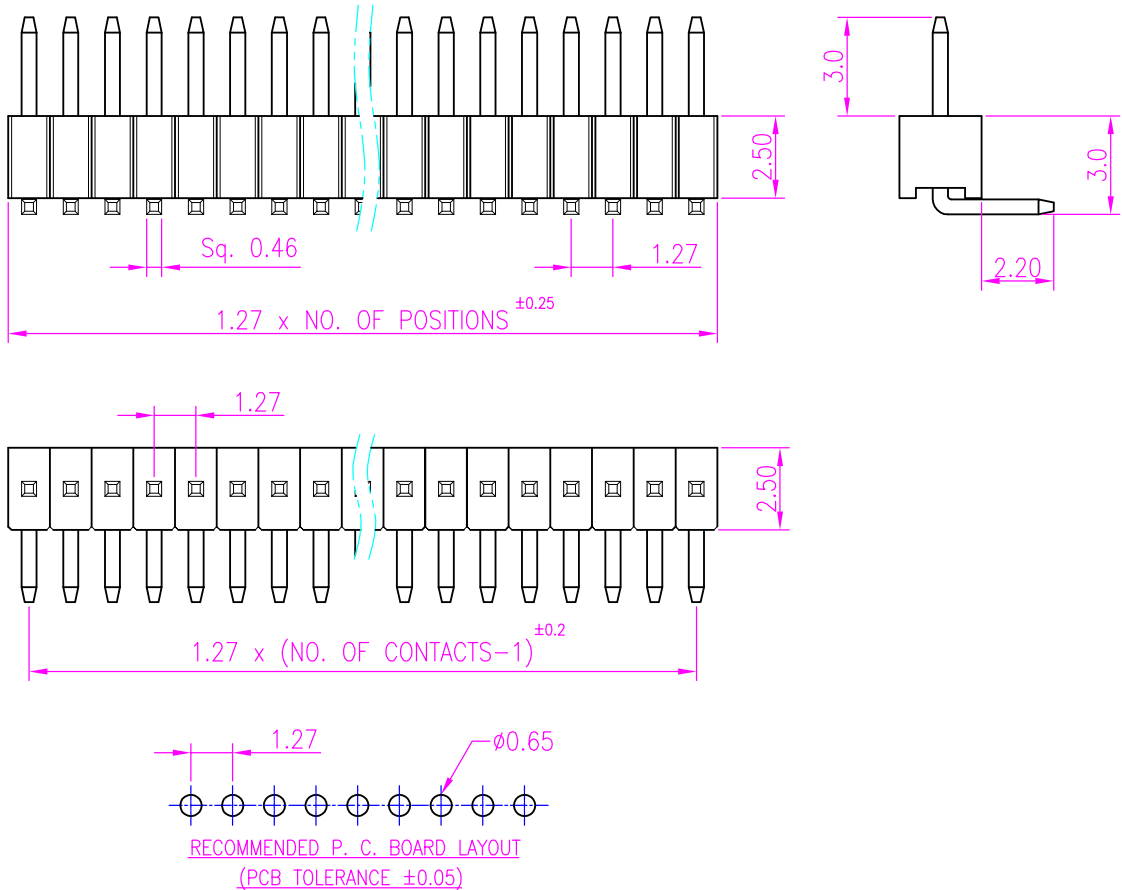

MATES WITH

P9431, P9431D
P9436

ORDERING INFORMATION

P9132-XXX36-1

NO OF CONTACTS
(02-40)

MOQ- ----

SPQ- ----

FOR DIFFERENT PIN LENGTH AND PLATING, CONTACT FACTORY

A	ORIGINAL	SANDHYA	28.04.2006		
REV.	DESCRIPTION	DRN. BY	DATE	CK'ED BY	APP'D BY

Projection:

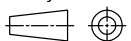

Scale: NTS

Sht. Size: A4

Gen. Tol.: ± 0.15

ALL DIMENSIONS ARE IN MM.
IF UNLESS OTHERWISE SPECIFIED.