



PROTECTRON ELECTROMECH (P) LTD

DESCRIPTION : HOUSING FOR 2.54mm PITCH SHROUDED WAFER,
CRIMP TYPE

PART NO: P9072H20-00-X
X=NO. OF WAYS(2-12)

RoHS



PHYSICAL

INSULATION

MATERIAL	:	PBT 30% GF
FLAMMABILITY	:	UL94V-0
COLOR	:	BLACK COLOR
PACKAGING TYPE	:	BULK PACKING

ELECTRICAL

CURRENT RATING	:	2.5A
INSULATION RESISTANCE	:	1000M OHMS MIN
CONTACT RESISTANCE	:	20m OHMS MAX
VOLTAGE RATING	:	250V AC/DC
VOLTAGE PROOF	:	1000V AC/MIN

ENVIRONMENTAL DATA

TEMPERATURE RANGE	:	-25° TO +85° C
-------------------	---	----------------



PROTECTRON ELECTROMECH (P) LTD

DESCRIPTION : HOUSING FOR 2.54mm PITCH SHROUDED WAFER, CRIMP TYPE

PART NO: P9072H20-00-X
X=NO. OF WAYS(2-12)

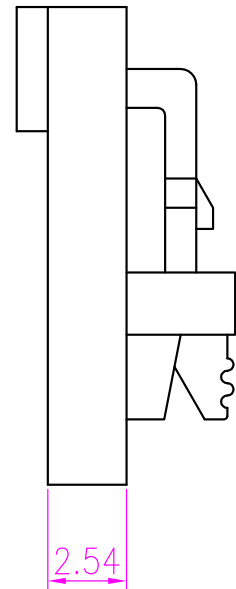
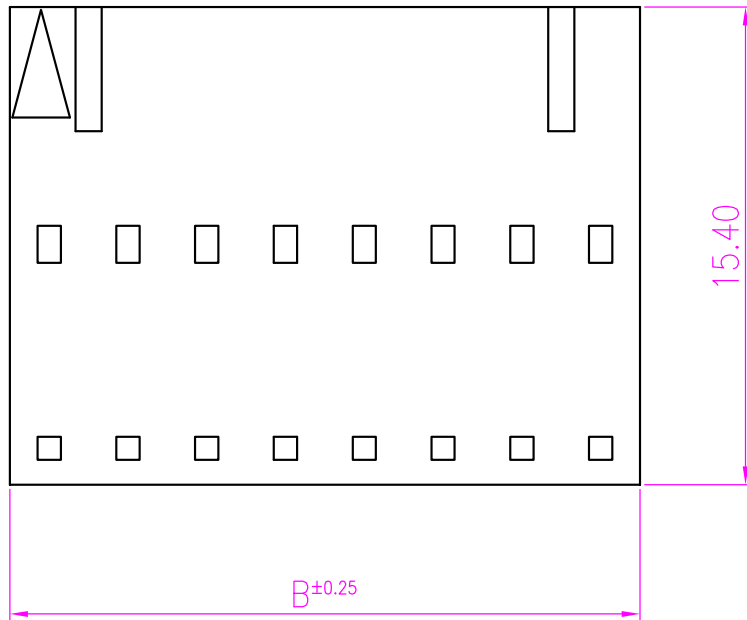
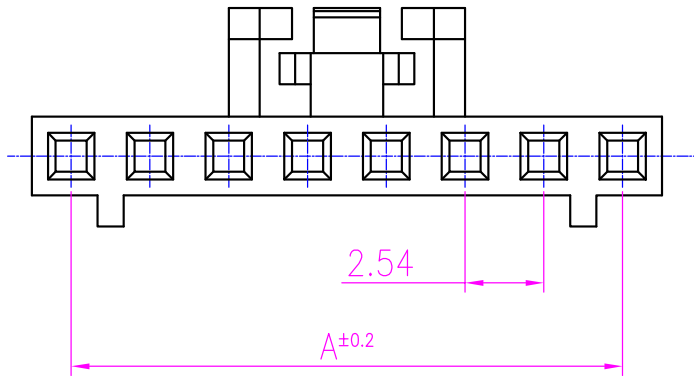

A	ORIGINAL			SANDHYA	04.11.2006		
REV.	DESCRIPTION			DRN. BY	DATE	CK'ED BY	APP'D BY
Projection: 		Scale: NTS	Sht. Size: A4	Gen. Tol.: $\pm 0.1\text{mm}$ $\pm 0.2^\circ$	ALL DIMENSIONS ARE IN MM. IF UNLESS OTHERWISE SPECIFIED.		



PROTECTRON ELECTROMECH (P) LTD

DESCRIPTION : HOUSING FOR 2.54mm PITCH SHROUDED WAFER,
CRIMP TYPE

PART NO: P9072H20-00-X
X=NO. OF WAYS(2-12)

ORDERING INFORMATION

P9072H20-00-X

NO OF WAYS
(2-12)

PART NO.	DIMENSIONS	
	A	B
P9072H20-00-2	2.54	5.20
P9072H20-00-3	5.08	7.80
P9072H20-00-4	7.62	10.30
P9072H20-00-5	10.16	12.90
P9072H20-00-6	12.70	15.40
P9072H20-00-7	15.24	18.00
P9072H20-00-8	17.78	20.50
P9072H20-00-9	20.32	23.10
P9072H20-00-A	22.86	25.60
P9072H20-00-B	25.40	28.10
P9072H20-00-C	27.94	30.70

MATES WITH

MATING CONNECTOR:
P9072S/P9072R &
P9072T SERIES

MOQ- ----

SPQ- ----